

Township N^o 12 South

Range N^o 12 East

of Mount Diablo Meridian

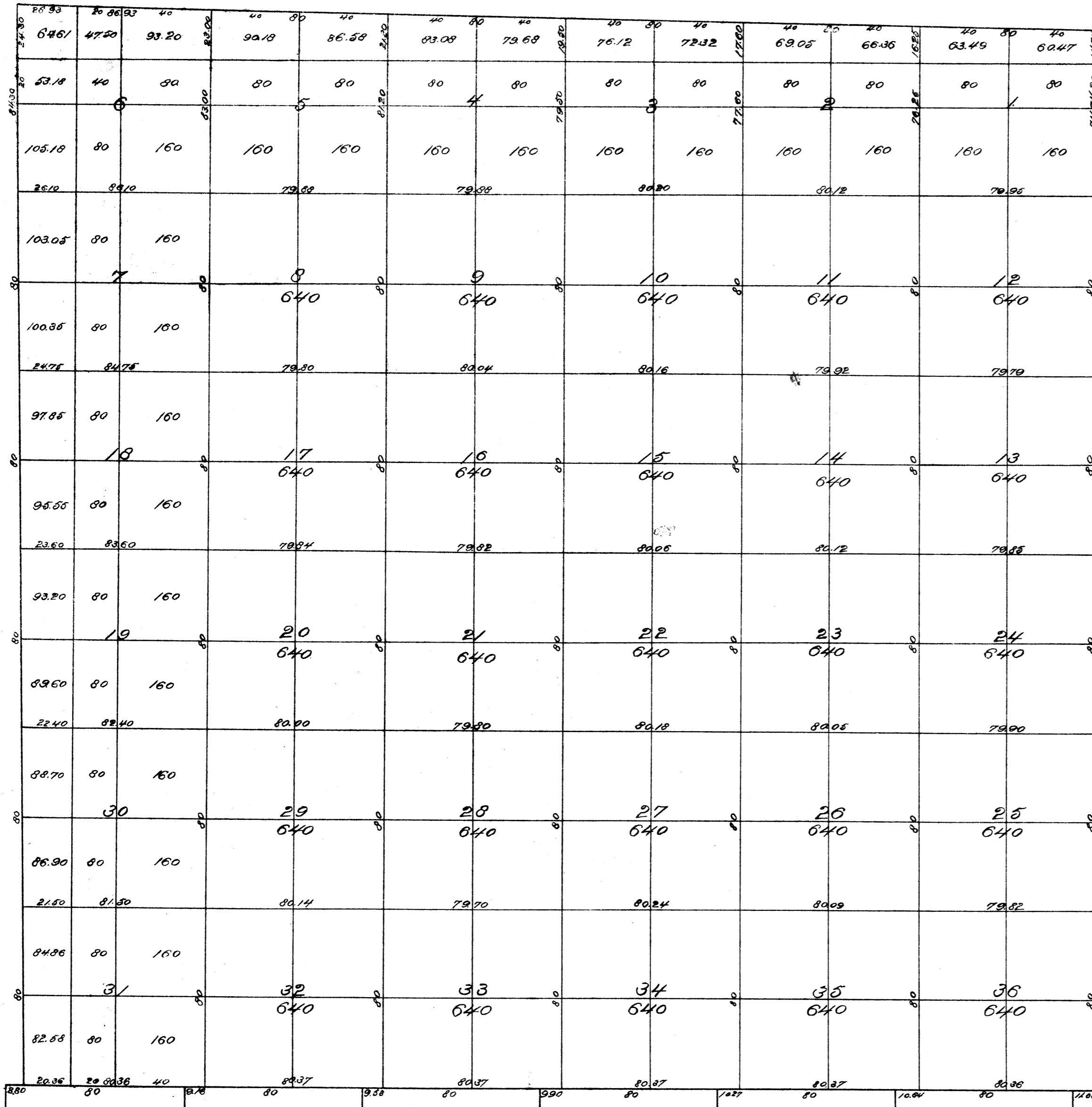

The above plat of Township N^o 12 South Range N^o 12 East (of Mount Diablo Base & Meridian Line) has been made out from and in conformity to the Field Notes of the undermentioned Surveys thereof, returned to and filed in this Office, which have been examined and approved

Under Contract		Work executed and exhibited	Distance		Cost		Payments charged in the Accounts of the Surveyor General for the	
Dated	With		Miles	Chains	Dollars	Cents		
August 26 th 1853	C. C. Tracy	North Boundary of the Township	6	6	93	85	21	1 st Quarter 1854
"	"	East	5	74	74	83	08	"
"	"	South	8	2	20	90	41	"
"	"	West	6	4	30	84	75	"
April 18 th 1854	"	Section Lines	60	15	25	722	29	2 nd & 3 rd Quarter 1854
					1065		74	8 th & 1 st Quarter 1855

Surveyor General's Office
San Francisco, California
March 15th 1855

John W. Kearney

Surveyor General, California

DEPARTMENT OF THE INTERIOR
GEOLOGICAL SURVEY

Washington, D. C. *Feb 7 1897*

I hereby certify that this plat of township is a true and literal exemplification of the township plat of survey to which it purports to refer, now on file in this office.

W. H. Richardson

T12S R12E MD