

E. D. V.
D.
D. 728

Township N° 11 South Range N° 12 East of Mount Diablo Meridian

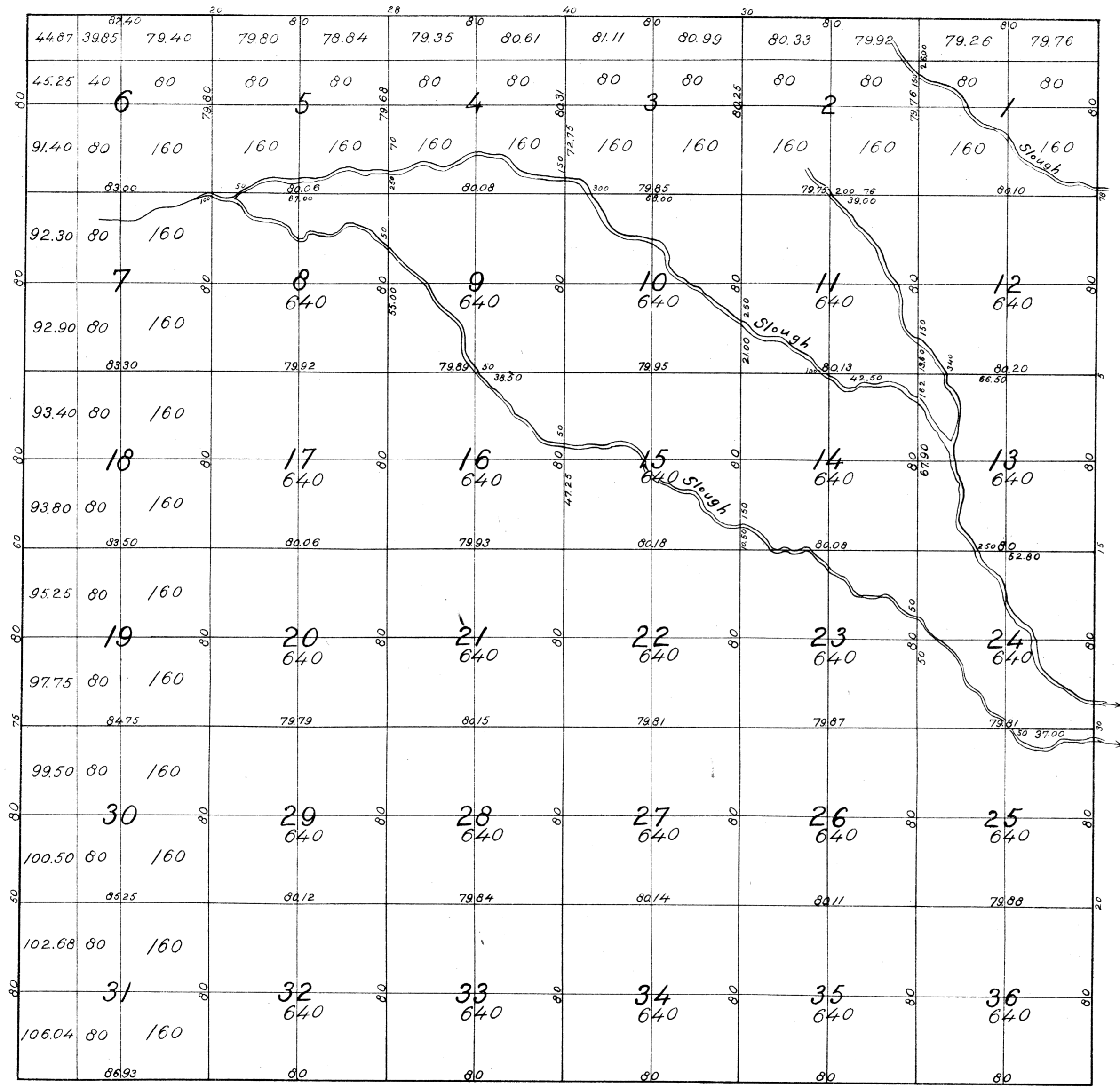

Var. 15° 20' E

The above plat of Township N° 11 South Range N° 12 East (of Mount Diablo Base & Meridian Line) has been made out from and in conformity to the field notes of the undermentioned Surveys thereof, returned to & filed in this office, which have been examined and approved.

Under Contract		Work executed & exhibited	Distance Miles Chs Lks	Cost Dollrs Cents	Payments charged in the accounts of the Surveyor General for the
Dated	With				
August 26 th 1853	C. C. Tracy	North Boundary of Township	6 2 40	84 42	1 st Quarter 1854
" "	" "	East " " "	6 00 00	84 00	" " "
" "	" "	South " " "	6 6 93	85 21	" " "
" "	" "	West " " "	6 00 00	84 00	" " "
April 18 th 1854	" "	Section Lines	60 19 30	722 89	2 nd & 3 rd Quarter 1854 & 1 st Quarter 1855
				1060 52	

Surveyor General's Office
San Francisco California
March 15th 1855

DEPARTMENT OF THE INTERIOR,
GENERAL LAND OFFICE,
Washington, D. C. *March 25, 1902.*
I hereby certify that this is a true copy
of the plat of official survey of the lands
to which it relates, on file in this office.

John W. May
Surveyor General California

Fred Bennett
Acting Recorder, General Land Office.