

Township N^o 10 South, Range N^o 11 East, of Mount Diablo Meridian.

J.B.P.

OK
T.S.P.
J.B.P.

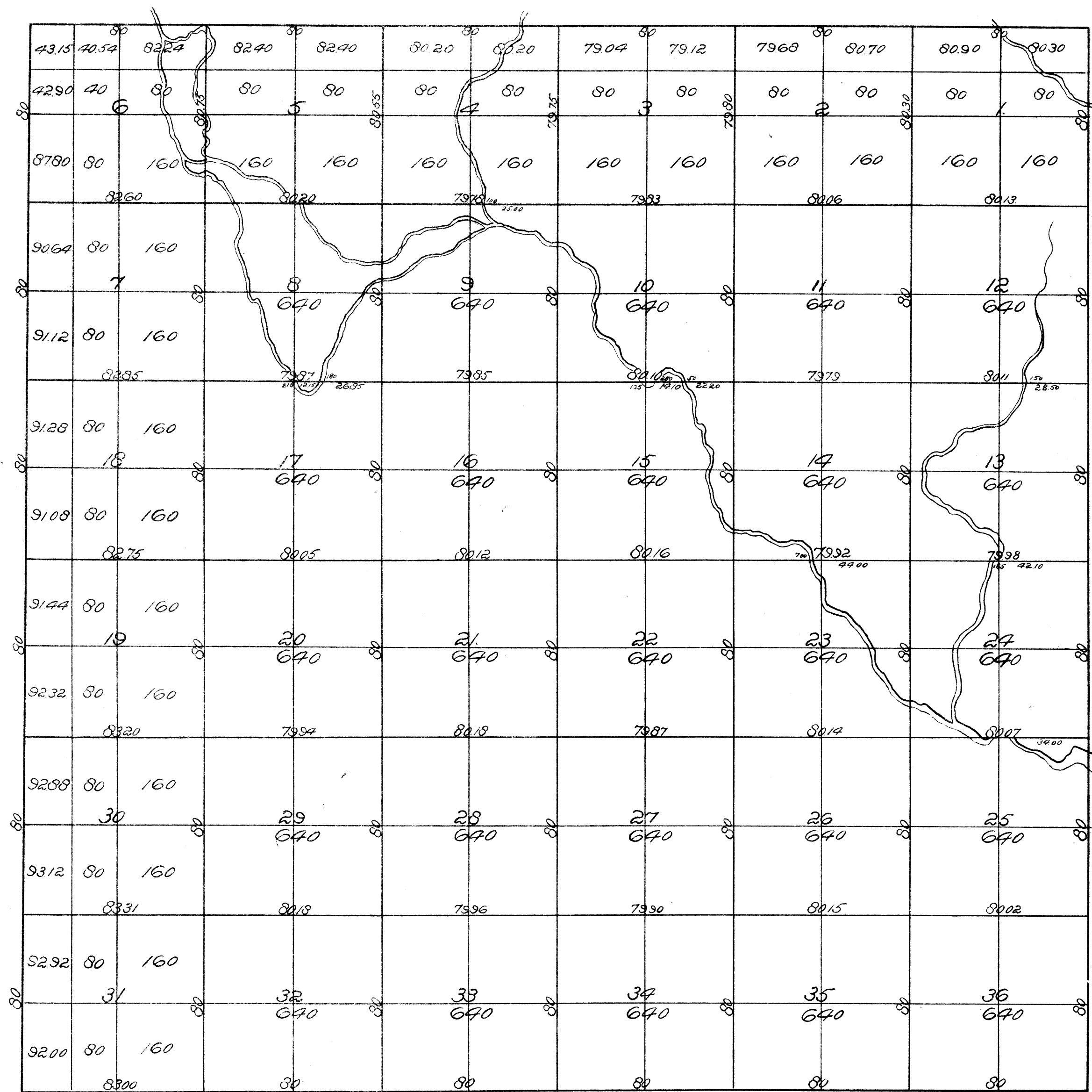

The above plat of Township N^o 10 South, Range N^o 11 East (of Mount Diablo Base & Meridian line) has been made out from and in conformity to the field notes of the undermentioned Surveys thereof, returned to and filed in this Office, which have been examined and approved.

Under Contract		Work executed and exhibited	Distance		Cost	Payments charged in Accounts of the Surveyor General for the	
Dated	With		Miles	Chas. 1/100	Dollar Cents		
August 26 th 1853	C.C. Tracy	North Boundary of Township	6	00	00	84 00	1 st Quarter 1854
"	"	East	6	00	00	84 00	"
"	"	South	6	03	00	84 52	"
"	"	West	6	00	00	84 00	"
April 18 th 1854	"	Section lines	60	16	12	722 40	2 nd 3 rd Quars 1855.
						1058 92	

Surveyor Generals Office
San Francisco California
March 15-1855.

John C. Hoag

Surveyor General California.

DEPARTMENT OF THE INTERIOR
GENERAL LAND OFFICE

102

Washington, D. C. Jan 24th 1857.

I hereby certify that this photolithograph is a true and literal exemplification of the township plat of survey to which it purports to relate, as on file in this office.

W. A. Richards
Commissioner