

OK G.F.F. F.A.B.

Township N^o 10 South Range N^o 10 East of Mount Diablo Meridian.

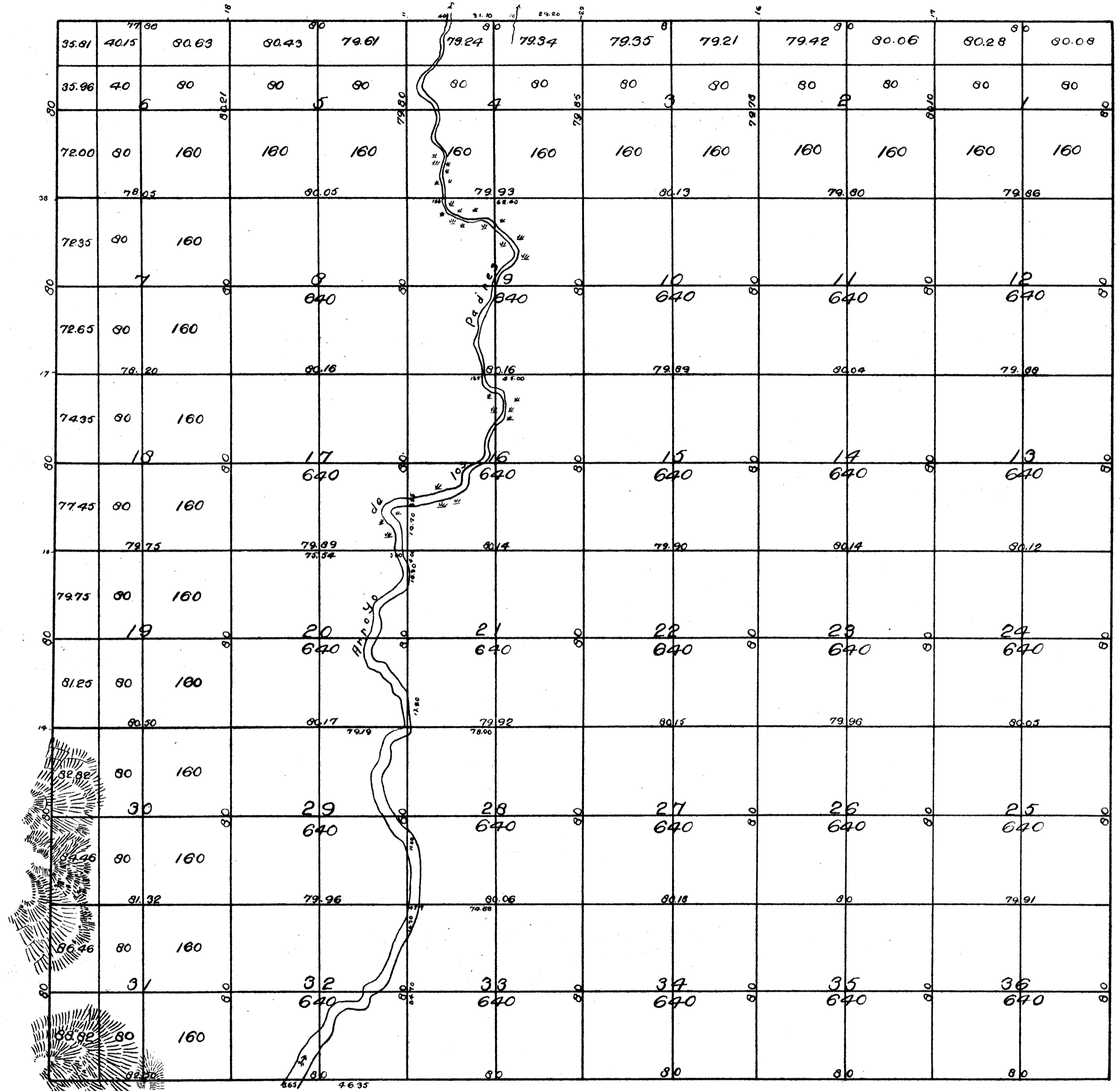

G.J.

Total area 23114 acres

The above plat of Township N10South, Range N10East (of Mount Diablo Base & Meridian Line) has been made out from and in conformity to the field notes of the undermentioned Surveys thereof, returned to and filed in this Office, which have been examined and approved

Under Contract	Work executed and exhibited	Distance		Cost		Payments charged in accounts of the Surveyor General for the
		Miles	ch	Dollars	Cents	
August 26 th 1853	North Boundary of the Township	5	77	86	83	63
" " "	East " " " "	6	0	00	84	00
" " "	South " " " "	6	2	50	84	44
" " "	West " " " "	6	0	00	84	00
April 18 th 1854	Section Lines " " "	59	78	01	719	70
				1,055	77	

Surveyor General's Office
San Francisco California
March 15th 1855

DEPARTMENT OF THE INTERIOR
SURVEYOR GENERAL'S OFFICE
San Francisco, D. C. Jan. 22, 1857.
I hereby certify that this photograph is a true and literal exemplification of the original plat of survey to which it purports to refer, and on file in this office.

W. A. Richards
Surveyor General

John W. W. W. W.
Surveyor General California.