

Township N° 9 South,

Range N° 12 East,

Mount Diablo Meridian.

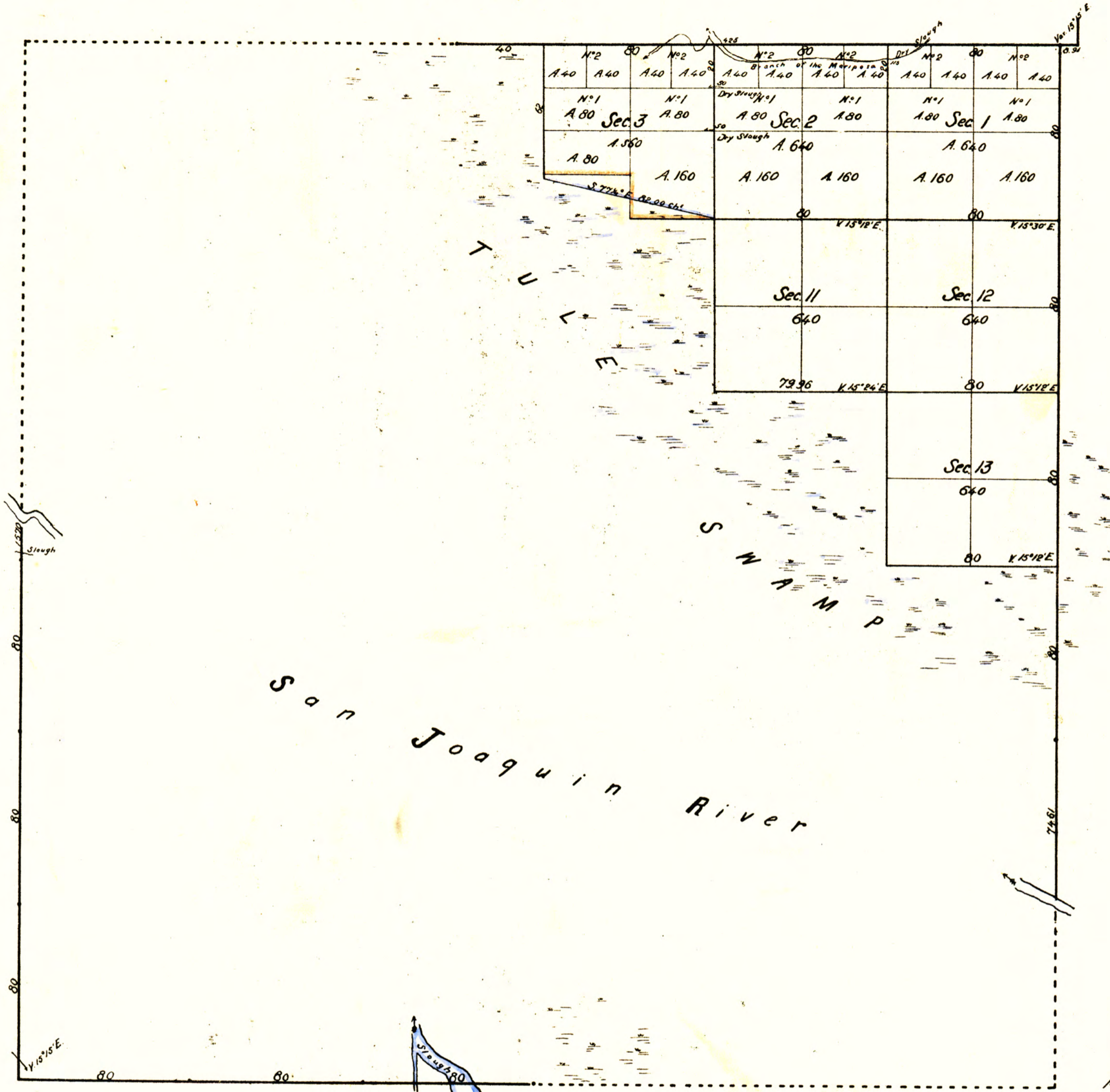

A.F.W. O.K. J.B.S.J. G.F.P.

Aggregate Area of Public Lands/surveyed/ 3760.00 Acres
 Estimated - - - Tule Swamps/not surveyed/ 19280.00 - - -
 Aggregate 23040.00 - - -

Meridians run at a Variation of 15° 12' East.

| Surveys designated | By whom surveyed | Date of Contract | Amount of Surveys Miles Chains Links | When Surveyed |
|----------------------------|-------------------|------------------------------|---|---------------|
| North boundary of Township | A. W. Van Schmidt | May 26 th 1853 | 3 40 00 | 1853 |
| Rest of Township lines | C. C. Tracy | August 26 th 1853 | 11 10 31 | 1854 |
| Section lines | Archibald McNeill | June 12 th 1856 | 10 61 96 | 1856 |
| Meanders | - - - - - | - - - - - | 1 02 00 | - - - - - |

The above Map of Township N° 9 South, Range N° 12 East / Mount Diablo Meridian / is strictly conformable to the fieldnotes of the Survey thereof on file in this Office, which have been examined and approved.

Surveyor General's Office.
San Francisco California.
December 1st 1856.

DEPARTMENT OF THE INTERIOR,
GENERAL LAND OFFICE,

Washington, D. C. Feb. 1 1857.

I hereby certify that this photo-lithograph is a true and literal exemplification of the township plat of survey to which it purports to refer, now on file in this office.

John B. Hoag.

Surveyor General California. W. A. Richards

Commissioner.