

Township N° 8 South, Range N° 13 East, of the Mount Diablo Meridian.

J. B. P.  
S. F. S.  
G. P.

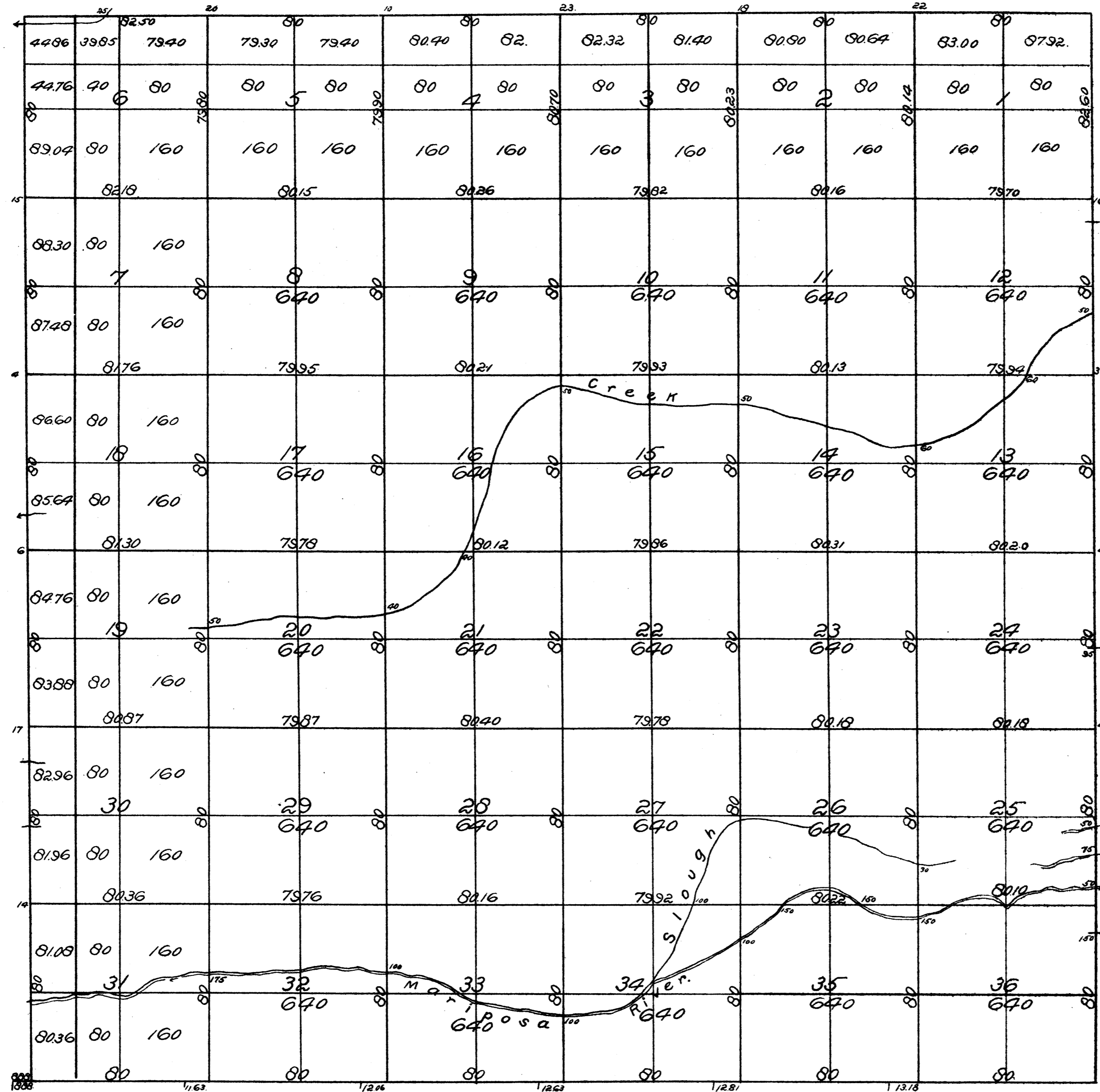

The above plat of Township N° 8 South, Range N° 13 East, (of Mount Diablo Meridian) has been made out from and in conformity to the field notes of the undermentioned Surveys thereof, returned to and filed in this Office, which have been examined and approved.

Total number of Acres 23,116.93.

Under Date	Contract With	Work executed and exhibited	Distance			Cost		Payments charged in account of the Surveyor General for the
			Miles	Chs	1/4s	Doll's	Cts	
May 26 <sup>th</sup> 1853	A. W. Von Schmidt	North Boundary of Township	6	02	00	84	35	2 <sup>nd</sup> Quarter 1853.
October 21 <sup>st</sup> 1852, Sept 1 <sup>st</sup> 1853	" " "	East " " "	6	02	60	84	45	" " " 1852.
September 3 <sup>rd</sup> 1853	Fred. R. Loring	South " " " 2 <sup>nd</sup> Standard	6	00	00	90	00	" " " 1852.
		West " " " p <sup>o</sup> s as Meridian	6	00	00	90	00	" " " 1853.
		Section lines.	60	08	33	721	25	
						1070	05	

Surveyor General's Office  
San Francisco California,  
February 28<sup>th</sup> 1854.

John McKeay  
Surveyor General California.

DEPARTMENT OF THE INTERIOR,  
GENERAL LAND OFFICE,

Washington, D. C. Jan 24 1897.

I hereby certify that this photo-lithograph is a true and literal exemplification of the township plat of survey to which it purports to relate, now on file in this office.

W. A. Richardson  
Commissioner