

Township N^o 8 South,

Range N^o 8 East,

Mount Diablo Meridian.

1853
J.B.S.
C.F.F.

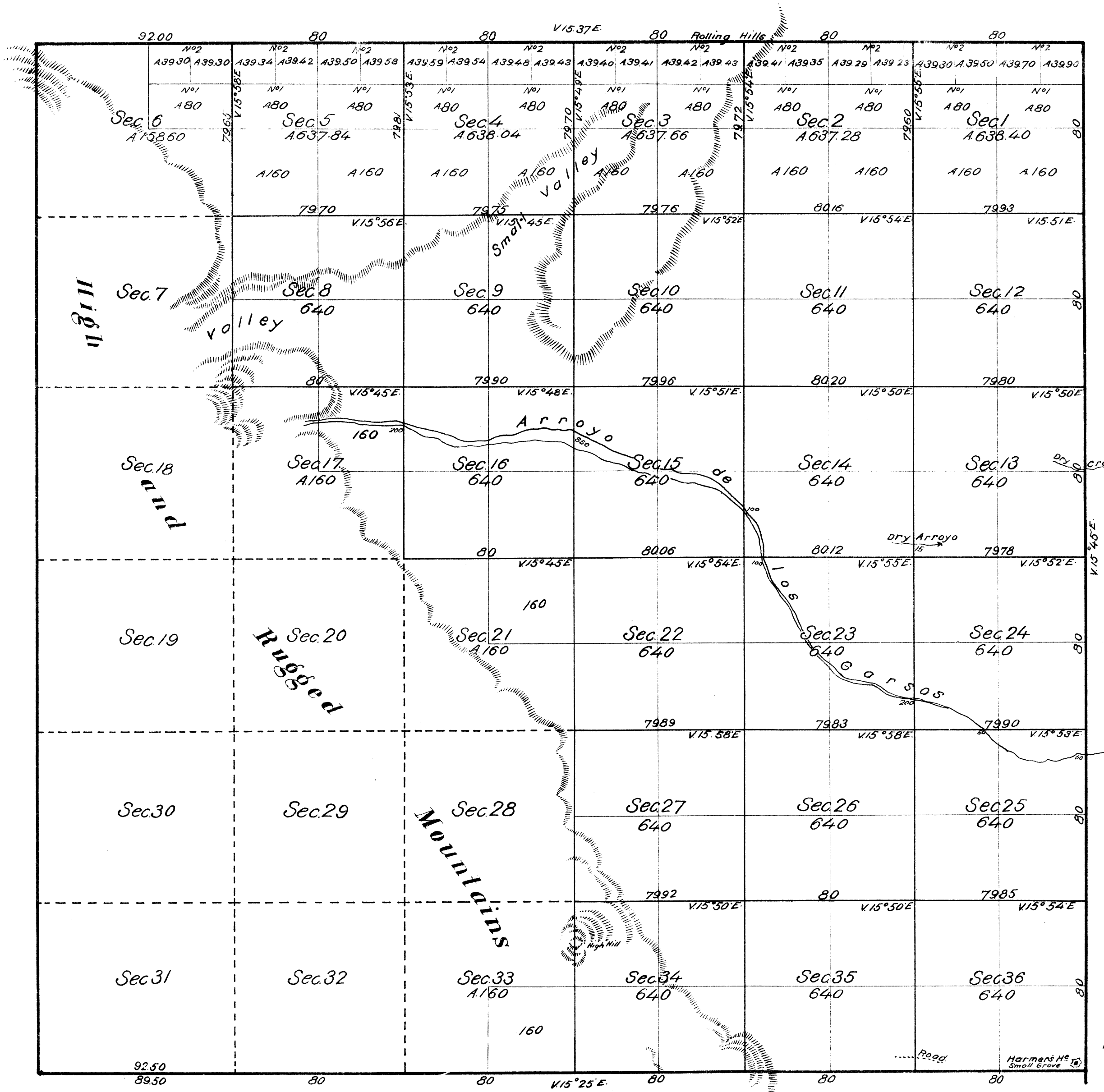

Aggregate Area of Public land (Surveyed) 15,347.7
 Estimated - - Mountain " (not surveyed) 8,266
Aggregate, 23, 613.95

The North boundary of the Township is returned at present.

Meridian lines not otherwise noted run at a variation of 15°45' East.

Surveys Designated	By Whom Surveyed	Date of Contract.	Amount of Surveys	When Surveyed
East boundary of Township	A. W. Van Schmidt	May 26 th 1853	6 00 00	1853
South	Henry Washington	November 27 th 1858	6 12 50	1858
North	J. E. Terrell	July 2 nd 1859	6 12 00	1859
Section lines	" " "	" " "	42 76 99	October 20 th 1859

The above map of Township N^o 8 South, Range N^o 8 East, Mount Diablo Meridian is strictly conformable to the field notes of the Surveys thereof on file in this office which have been examined and approved.
 Surveyor General's Office
 San Francisco California
 January 4th 1860

DEPARTMENT OF THE INTERIOR,
 GENERAL LAND OFFICE,
 Washington, D. C. Feb. 14, 1907. *J. W. Mandeville*
 I hereby certify that this photo-lithograph is a true and literal exemplification of the township plat of survey to which it purports to relate, now on file in this office.
W. A. Richard
 Commissioner.
 U.S. Surveyor General Cal^a
T8S R8E MD