

11. 6. 77.
J.B.S. Jr.
G.L.

Township N° 5 South Range N° 11 East Mount Diablo Meridian.

See Surveyor Genl's letter of Feb 27th 1868 1st Standard South

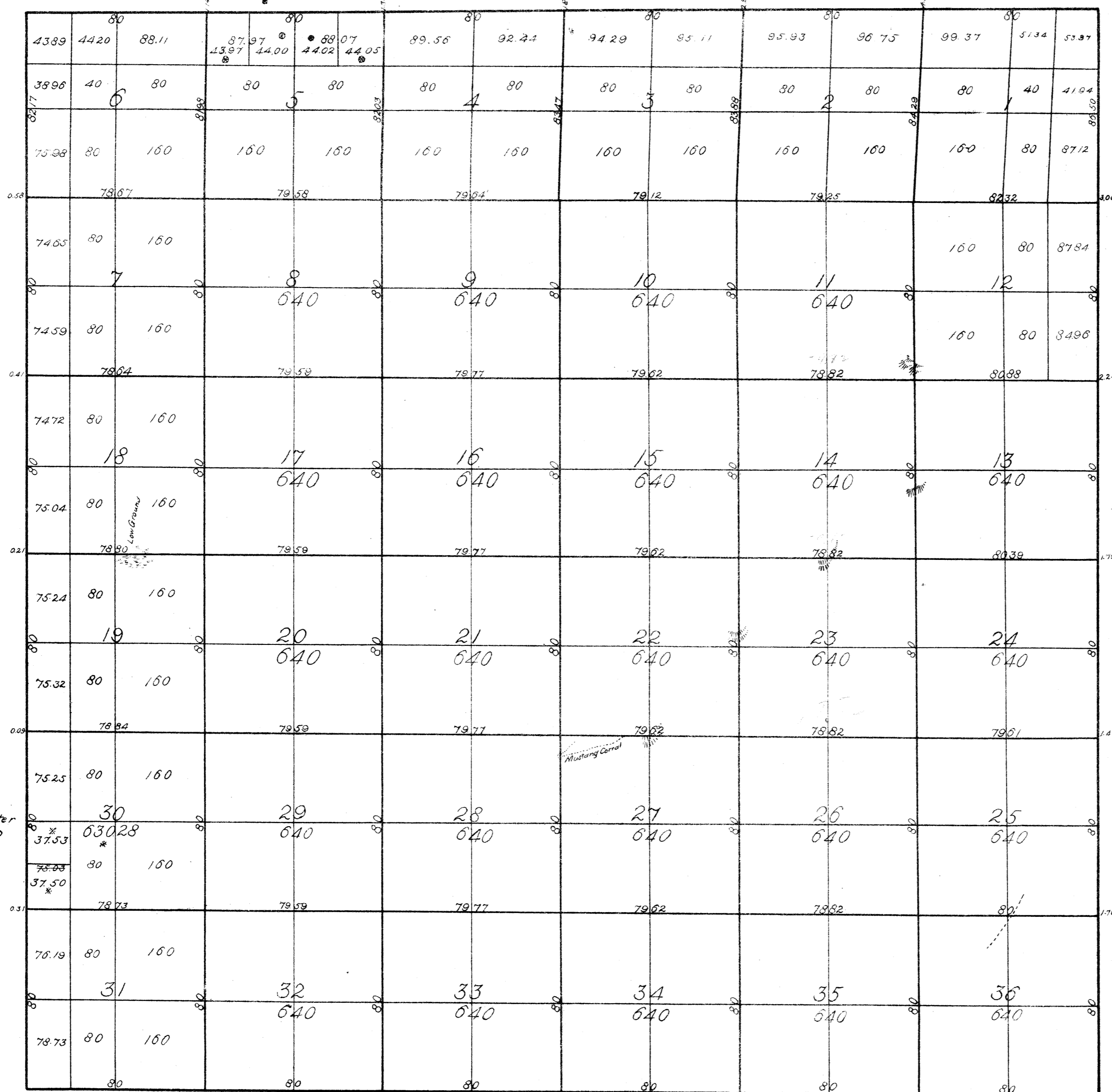

* See Sur. Genl's letter of Aug 27th 1868

The above plat of Township N° 5 South, Range N° 11 East "Mount Diablo Meridian" has been made out from & in conformity to the field notes of the undermentioned surveys thereof, returned to & filed in this Office, which have been examined & approved

Under Contract		Work executed & exhibited	Distance			Cost		Payments charged in Accounts of the Surveyor General for the
Dated	With		Miles	Chs	Lks	Dollars	Cents	
April 3 rd 1854	A. W. Van Schmidt	North Boundary of Township	6	00	00	90		2 nd & 3 rd Quarters 1854
Oct. 21 st 1852. Sep. 1 st 1853	"	East "	6	06	50	85	13	" " " 1853
April 3 rd 1854	"	South "	6	00	00	90		" " " 1854
November 29 th 1853	Wm. Denton	West "	6	02	17	84	38	2 nd & 3 rd " 1854
		Section Lines "	60	01	32	720	20	1 st & 2 nd " 1854
						1069	71	

Surveyor General's Office
San Francisco California
March 15th 1855

John W. Beatty
Surveyor General California.

DEPARTMENT OF THE INTERIOR
GENERAL LAND OFFICE
Washington, D. C. Feb 1 1907
I hereby certify that this photo-lithograph is a true and literal exemplification of the town plat of survey to which it purports to relate, and is on file in this office.