

Township N° 5 South Range N° 10 East Mount Diablo Meridian

L & L

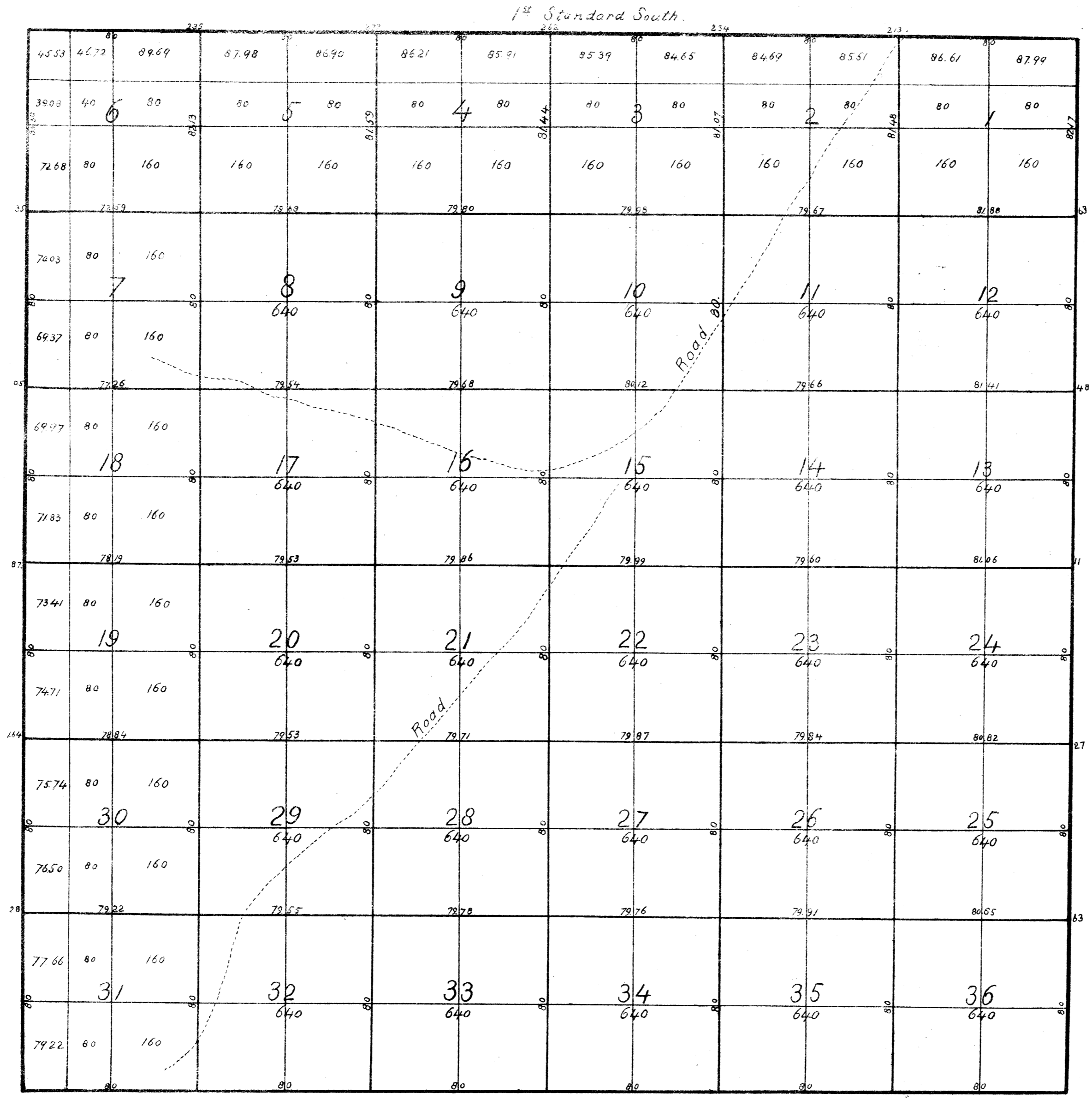

The above plat of Township N° 5 South, Range N° 10 East Mount Diablo Meridian has been made out from & in conformity to the field notes of the undermentioned Surveys thereof returned to & filed in this Office, which have been examined & approved.

Under Contract	Dated	With	Work executed & exhibited.	Distance		Cost		Payments charged in Accounts of the Surveyor General for the
				Miles	Fms	Dollars	Cents	
April 3 rd 1854		A W Bm Schmidt	North Boundary of Township Stand	6	00	90		2 nd & 3 rd Quarters 1854
Oct. 21 st 1852	Sept. 1 st 1853		East	6	02	17	84	36
April 3 rd 1854			South	6	00	90		1853
November 24 th 1853		Wm Denton	West Section Lines	6	03	30	84	56
				59	79	70	719	95
							1068	89

Surveyor General's Office
San Francisco California.
March 15th 1855

John C. Hoays

Surveyor General California

DEPARTMENT OF THE
Wash. ton, D. C. Jan. 22, 1907.
I hereby certify that this photolithograph is a true and literal exemplification of the township plat of survey to which it purports to relate, now on file in this office.

44 323

Wm. A. Richards
T5SR10E MD