

CORNER RECORD

COUNTY OF San Diego MERIDIAN San Diego CALIF.
 COURSE FOR CORNER TOLLY AND TAGGED PREPARISHED CALIBRATED COLLAR ALIQUOT
 COURSE IDENTIFICATION - DATE OF USE 11/15/76

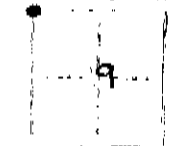

North Corner Sec. 19, T. 14 N.

COURSE FOR CORNER TOLLY AND TAGGED PREPARISHED CALIBRATED COLLAR ALIQUOT
 COURSE IDENTIFICATION OF COURSE COURSE: EVIDENCE AND METHOD USED TO IDENTIFY OR RECALIBRATE

Revised 1/16/76 from 11/15/76
RECALIBRATED 1/16/76 AND 8/27/78

EXACT DESCRIPTION OF ADJACENTS PROPERTY OR EMBODIMENT

CALIFORNIA COORDINATE SYSTEM ORDER FIRST SECOND THIRD
 STATIONING METHOD (SOUTH & WEST) SOUTH COURSE OTHER STATION STATION
 COURSE ELEVATION BENCHMARK (M)

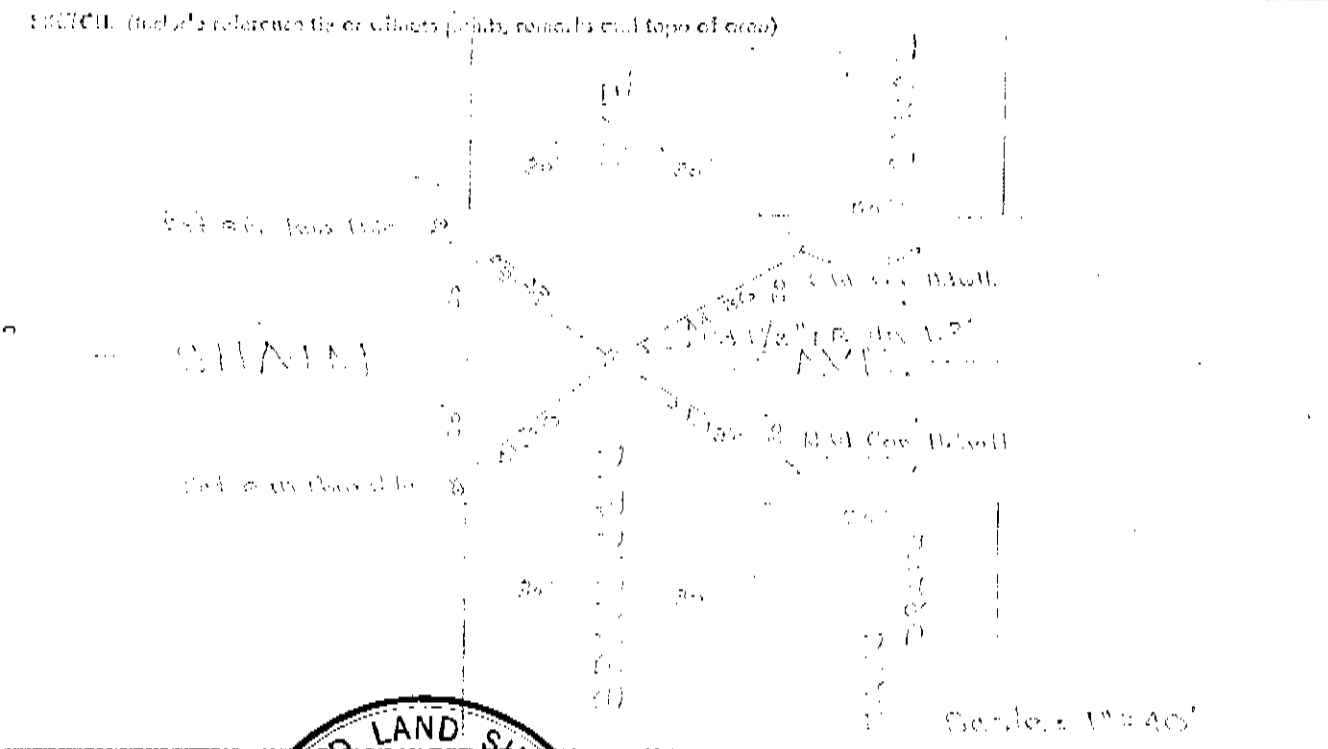

STAIN

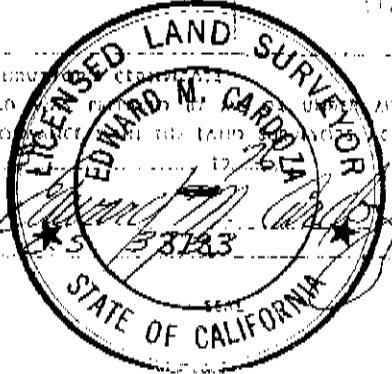

THIS CORNER DESCRIBED BY THIS SURVEYOR WAS RECALIBRATED BY CALIFORNIA SURVEYORS ASSOCIATION ON FEB. 1976
 SIGNED Edward M. Cardoza
 (S. or N. of)

COUNTY SURVEYORS REPRESENTATIVE
 THE CORNER BECAME WAS RECALIBRATED July 18, 1976
 AND EXAMINED AND FILED July 28, 1976
 BY John Dransky
 SURV ACE
 DOCUMENT NO. 00269
 STATEMENT ON BACK OF SHEET