

**CORNER RECORD**

COUNTY OF FRENDO 11 26 1976 M.D.R.A. MERIDIAN CALIF.  
 CORNER TYPE: GOVT. CORNER  BANNER  RANCH  CORNER  OTHER   
 COUNTY IDENTIFICATION: DATE OF CASE: 11 26 19 76

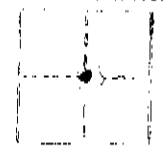

11 26 1976 11 26 1976 11 26 1976  
 ALSO 2 1/4 CORNER SEC 18

CORNER FOUND AS FOUND  FOUND AND TAPPED  ESTABLISHED OR BUILT CORNER  REBUILT

PHYSICAL DESCRIPTION OF CORNER E. (S); EVIDENCE AND METHOD USED TO IDENTIFY OR REESTABLISH:

Found 6" x 6" National down 1.5'  
Found 6" x 6" N.S. 2733

PHYSICAL DESCRIPTION OF MONUMENTS BEHIND OR FORWARDED

CALIFORNIA COORDINATE SYSTEM: FIRST  SECOND  THIRD   
 STATIONS USED: LOS (S.L.A. 011)  STATE  COUNTY  OTHER  STATION \_\_\_\_\_ ELEVATION \_\_\_\_\_  
 ZONE \_\_\_\_\_ EASINGS (R) \_\_\_\_\_

SKETCH (Include reference file or witness points, remarks and type of area)

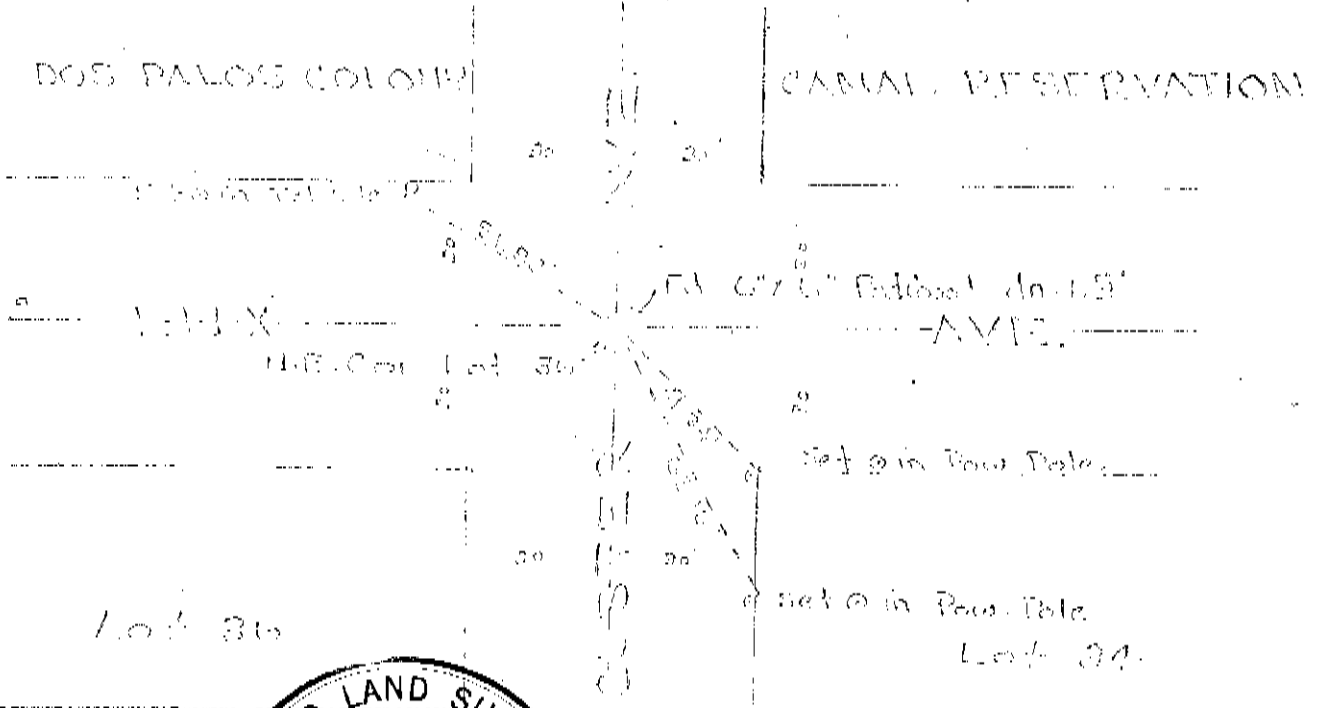

THIS CORNER RECORD WAS RECORDED BY \_\_\_\_\_  
 DIRECTION OF COUNTY \_\_\_\_\_  
 ON FEB \_\_\_\_\_  
 SIGNED: [Signature]  
 U.S. DEPT. OF THE INTERIOR  
 LICENSED LAND SURVEYOR  
 EDWARD M. CARDEN  
 5375733  
 STATE OF CALIFORNIA

COUNTY SURVEYOR'S CERTIFICATE  
 THE CORNER RECORD WAS RECORDED July 19, 1976  
 AND EXAMINED AND FOUND July 28, 1976  
 BY [Signature]  
 TITLE DUE  
 DOCUMENT NO. 00763  
 STATEMENT ON BACK OF SHEET