

CORNER TYPE: GOVT. CORNER MEANDER RANCHO CONTROL OTHER
CORNER IDENTIFICATION - DATE OF VISIT JAN 26 1984

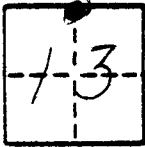

N 1/4 SEC 13 11/12

VALERIA & BRYANT AVES

CORNER - LEFT AS FOUND FOUND AND TAGGED REESTABLISHED OBLITERATED CORNER RESULT

PHYSICAL DESCRIPTION OF CORNER FOUND; EVIDENCE AND METHOD USED TO IDENTIFY OR REESTABLISH

FOUND 1/2 INCH ROD WITH PLASTIC CAP L.S # 456. 3" DOWN, DESTROYED DURING CONSTRUCTION
RE-ESTABLISHED CORNER BY TIES TAKEN PRIOR TO CONSTRUCTION

PHYSICAL DESCRIPTION OF MONUMENTS RESULT OR PERPETUATED

SET FRESNO COUNTY BRASS CAP MONUMENT FLUSH WITH PAVEMENT SURFACE
STAMPED RCE 12769

CALIFORNIA COORDINATE SYSTEM ORDER: FIRST SECOND THIRD
STATIONS USED: NGS (USC & GS) STATE COUNTY OTHER STATION _____ STATION _____
ZONE _____ ELEVATION _____ NORTHINGS (Y) _____ EASTINGS (X) _____

SKETCH: (Include reference tie or witness points, remarks and topo of area)

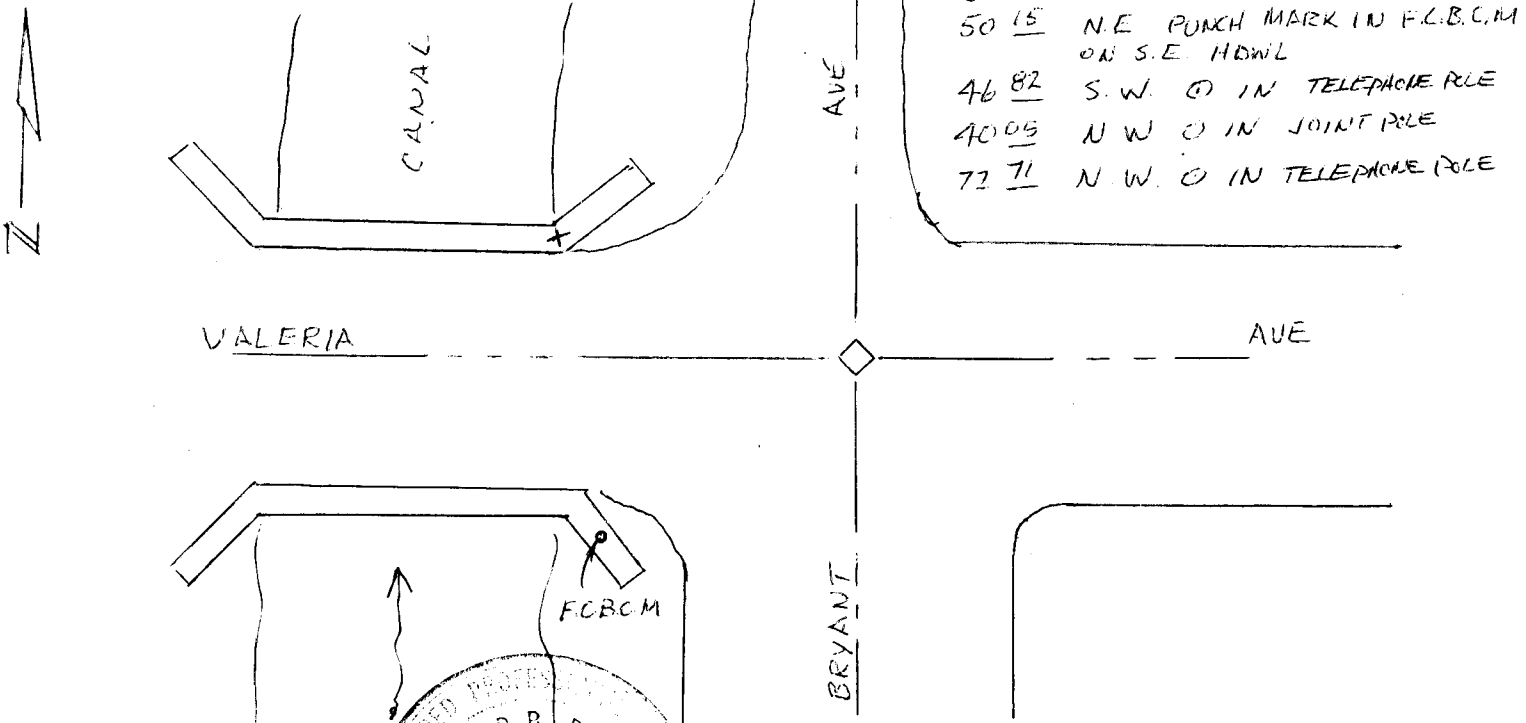

SURVEYOR'S CERTIFICATE
THIS CORNER RECORD WAS PREPARED BY ME OR UNDER MY DIRECTION IN CONFORMANCE WITH THE LAND SURVEYORS ACT ON 2-2 1984 FOR FRESNO COUNTY
SIGNED: Donald V. Dierker
R.C.E. No. 12769

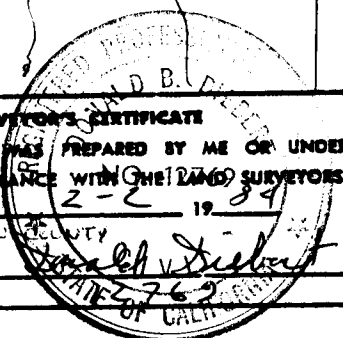

COUNTY SURVEYOR'S CERTIFICATE
THE CORNER RECORD WAS RECEIVED FEB. 6 1984 AND EXAMINED AND FILED FEB 17 1984
BY: Ray Spradley
TITLE: 11SE
DOCUMENT No. 3119
STATEMENT ON BACK OF SHEET YES NO