

City of \_\_\_\_\_ County of Merced, California

Brief Legal Description 3/4 Corner Section 31 8/14

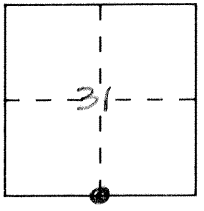

CORNER TYPE

COORDINATES (Optional)

- Government Corner  Control
- Meander  Property
- Rancho  Other
- Date of Survey \_\_\_\_\_

N. \_\_\_\_\_  
 E. \_\_\_\_\_  
 Zone \_\_\_\_\_ Datum \_\_\_\_\_  
 Elev. \_\_\_\_\_

Corner — Left as found  Found and tagged  Established  Reestablished  Rebuilt

Identification and type of corner found: Evidence used to identify or procedure used to establish or reestablish the corner:  
\_\_\_\_\_  
\_\_\_\_\_  
\_\_\_\_\_

A description of the physical condition of the monument as found and as set or reset: \_\_\_\_\_  
Fd 3/4" thick walled pipe.  
Monument box set over existing monument. 8-30-93  
F.B. 658-34

SURVEYOR'S STATEMENT

This Corner Record was prepared by me or under my direction in conformance with the Land Surveyors' Act on Sept. 7 1993.

Signed Lawrence L. Bowers L.S. or R.C.E. Number \_\_\_\_\_

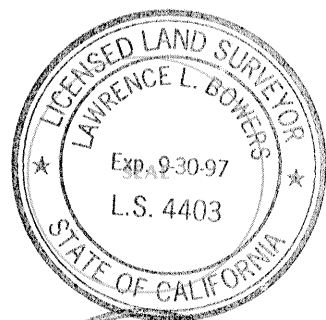

COUNTY SURVEYOR'S STATEMENT

This Corner Record was received SEPT. 1993 and examined and filed SEPT. 16, 1993.

Signed Roy L. Turney Title DEP. CO. SUR.

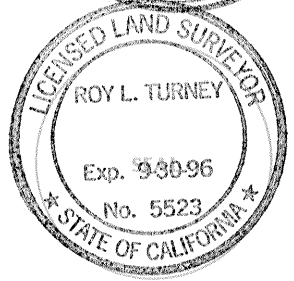

County Surveyor's Comment \_\_\_\_\_  
\_\_\_\_\_  
\_\_\_\_\_

SEC 31

1/4 SECTION LINE



SET NAIL & SHINER IN SW SIDE OF POWER POLE.

SET 3/4" IP W/BLANK TAG

SANDY

MUSH

ROAD

SOUTH 1/4 CORNER SEC. 31 3/4. FD. 3/4" THICK WALL PIPE.

Monument box set over 3/4" I.P.

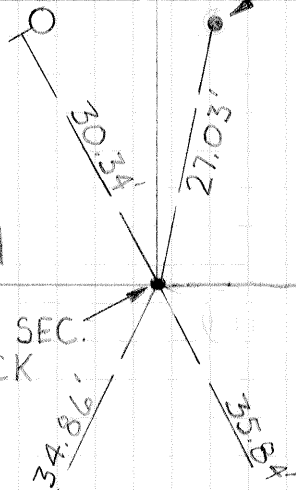

SET NAIL & SHINER IN EAST SIDE OF 8x10 FEN. CORNER POST.

GATE

SET NAIL & SHINER IN WEST SIDE OF 8x10 FEN. CORNER POST.

1/2 MILE EAST OF HWY 59.

SEC 6

POINTS WERE TIED OUT PRIOR TO PAVING EFFORT BY MERCED COUNTY DEPARTMENT OF PUBLIC WORKS