

CORNER RECORD

COUNTY OF Fresno T. 12 S R. 12 E M.D.B. & MERIDIAN CALIFORNIA

CORNER TYPE: GOV'T. CORNER MEANDER RANCHO CONTROL OTHER

CORNER IDENTIFICATION — DATE OF VISIT October 14, 19 85

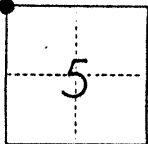

Northwest corner of Section 5, 12/12.

CORNER — LEFT AS FOUND FOUND AND TAGGED REESTABLISHED OBLITERATED CORNER REBUILT

PHYSICAL DESCRIPTION OF CORNER FOUND; EVIDENCE AND METHOD USED TO IDENTIFY OR REESTABLISH

3" x 3" redwood at ground surface.

PHYSICAL DESCRIPTION OF MONUMENTS REBUILT OR PERPETUATED

Set tag L.S. 5355

SKETCH: (Include reference tie or witness points, remarks and topo of area)

Ties

- 447.45' Northwest of nail and shiner in Power pole.
- 52.72' West of nail and shiner in Power pole.
- 262.01' East of nail and shiner in Power pole.
- 25' South of hinge point of ditch.
- 7.5' North of hinge point of ditch.

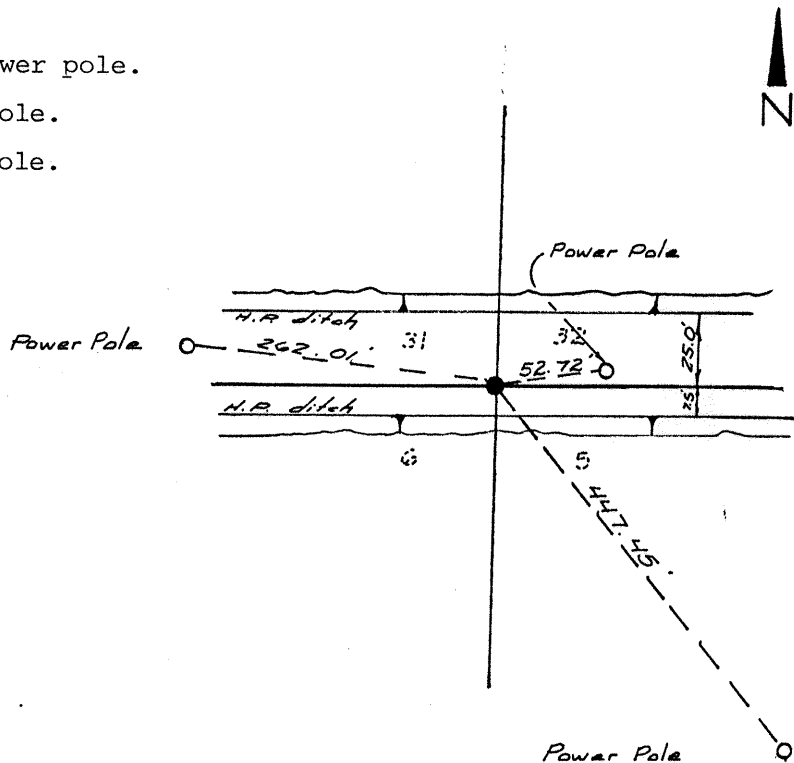

SURVEYOR'S CERTIFICATE

THIS CORNER RECORD WAS PREPARED BY ME OR UNDER MY DIRECTION IN CONFORMANCE WITH THE LAND SURVEYOR ACT ON November 19 85

SIGNED: Christopher L. White

L.S. or XXXX No.: 5355



COUNTY SURVEYOR'S CERTIFICATE

THE CORNER RECORD WAS RECEIVED 19 AND EXAMINED AND FILED 12-9 19 85

BY: Ray Turner
TITLE: Deputy County Surveyor

DOCUMENT No. 4038

STATEMENT ON BACK OF SHEET

YES NO