

CORNER RECORD

COUNTY OF Merced T. 10 S. R. 9 E. M.D.B. & MERIDIAN CALIFORNIA

CORNER TYPE: GOV'T. CORNER MEANDER RANCHO CONTROL OTHER

CORNER IDENTIFICATION — DATE OF VISIT November 5, 19 84



North quarter corner Section 15, 10/9

CORNER — LEFT AS FOUND FOUND AND TAGGED REESTABLISHED OBLITERATED CORNER REBUILT

PHYSICAL DESCRIPTION OF CORNER FOUND; EVIDENCE AND METHOD USED TO IDENTIFY OR REESTABLISH

Found 'T' bar flush with ground. Ties match USBR ties.

PHYSICAL DESCRIPTION OF MONUMENTS REBUILT OR PERPETUATED

Set tag L.S. 5355

SKETCH: (Include reference tie or witness points, remarks and topo of area)

- Ties
- 23.45' Southwest of nail & shiner in access Road.
- 170.38' Southeast of nail & shiner in guard rail post.
- 14.60' Northeast of new lip of concrete lining.
- 17.00' Northeast of old lip of concrete lining.
- 2635.70' East of northwest corner of Section 15.
- 2637.90' West of northeast corner of Section 15.

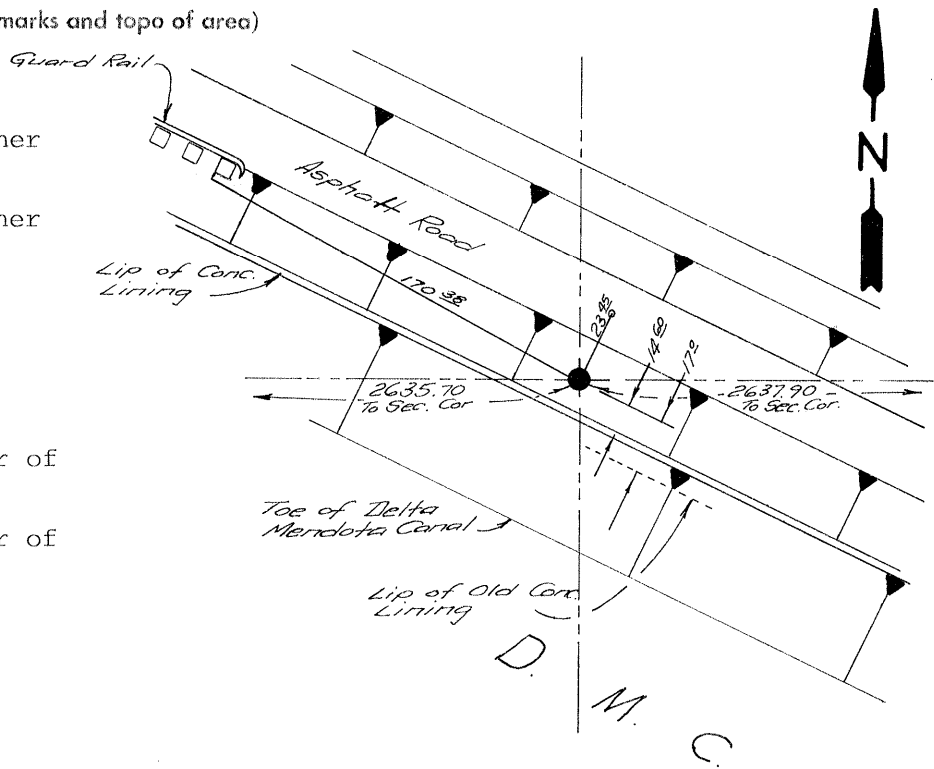

Book 84-4-34

SURVEYOR'S CERTIFICATE

THIS CORNER RECORD WAS PREPARED BY ME OR UNDER MY DIRECTION IN CONFORMANCE WITH THE LAND SURVEYORS ACT ON November 8 1984

SIGNED: Christopher White CHRISTOPHER WHITE

L.S. or R.C.E. No. 5355

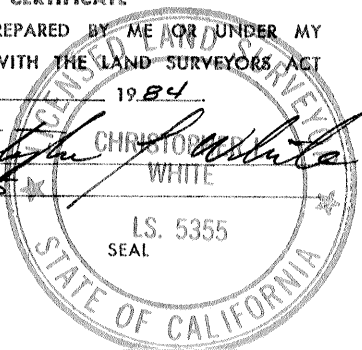

COUNTY SURVEYOR'S CERTIFICATE

THE CORNER RECORD WAS RECEIVED NOVEMBER 13, 1984 AND EXAMINED AND FILED NOVEMBER 13, 1984

BY: Roy Turner TITLE: DEPUTY COUNTY SURVEYOR

DOCUMENT No. LS 45528 4023

STATEMENT ON BACK OF SHEET

YES NO

