

13

CORNER RECORD

Document Number 4019

City of _____ County of MERCED, California

Brief Legal Description N.E. CORNER SECT. 29, T.10S. R.1E MDP&M

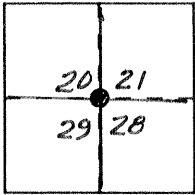

CORNER TYPE

Government Corner Control
 Meander Property
 Rancho Other
 Date of Survey 6-14-90

COORDINATES (Optional)

N. _____
 E. _____
 Zone _____ Datum _____
 Elev. _____

Corner — Left as found Found and tagged Established Reestablished Rebuilt

Identification and type of corner found: Evidence used to identify or procedure used to establish or reestablish the corner: BRASS CAP IN 2" I. PIPE MARKED 20, 21, 28, 29 US BUREAU OF RECLAMATION 23RS 26

A description of the physical condition of the monument as found and as set or reset: MONUMENT IN GOOD CONDITION, DOWN 1 1/2

SURVEYOR'S STATEMENT

This Corner Record was prepared by me or under my direction in conformance with the Land Surveyors' Act on JUNE 14 1990.

Signed Ralph M. Scheel, Jr. L.S. or R.C.E. Number LS 3730

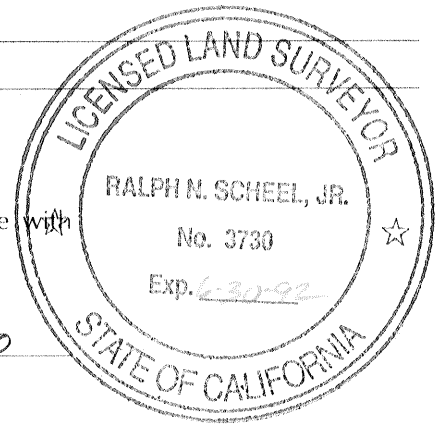

COUNTY SURVEYOR'S STATEMENT

This Corner Record was received August 1990 and examined and filed August 22 1990.

Signed Roy L. Turney Title Dep. Co. Surveyor

County Surveyor's Comment COR. No 4019

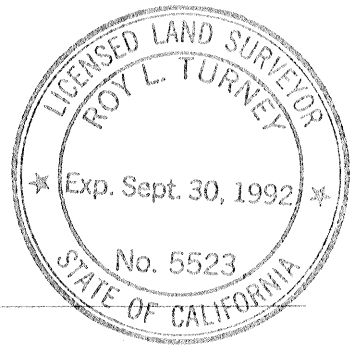

20	21	TIOSRIE
29	28	MDBEM

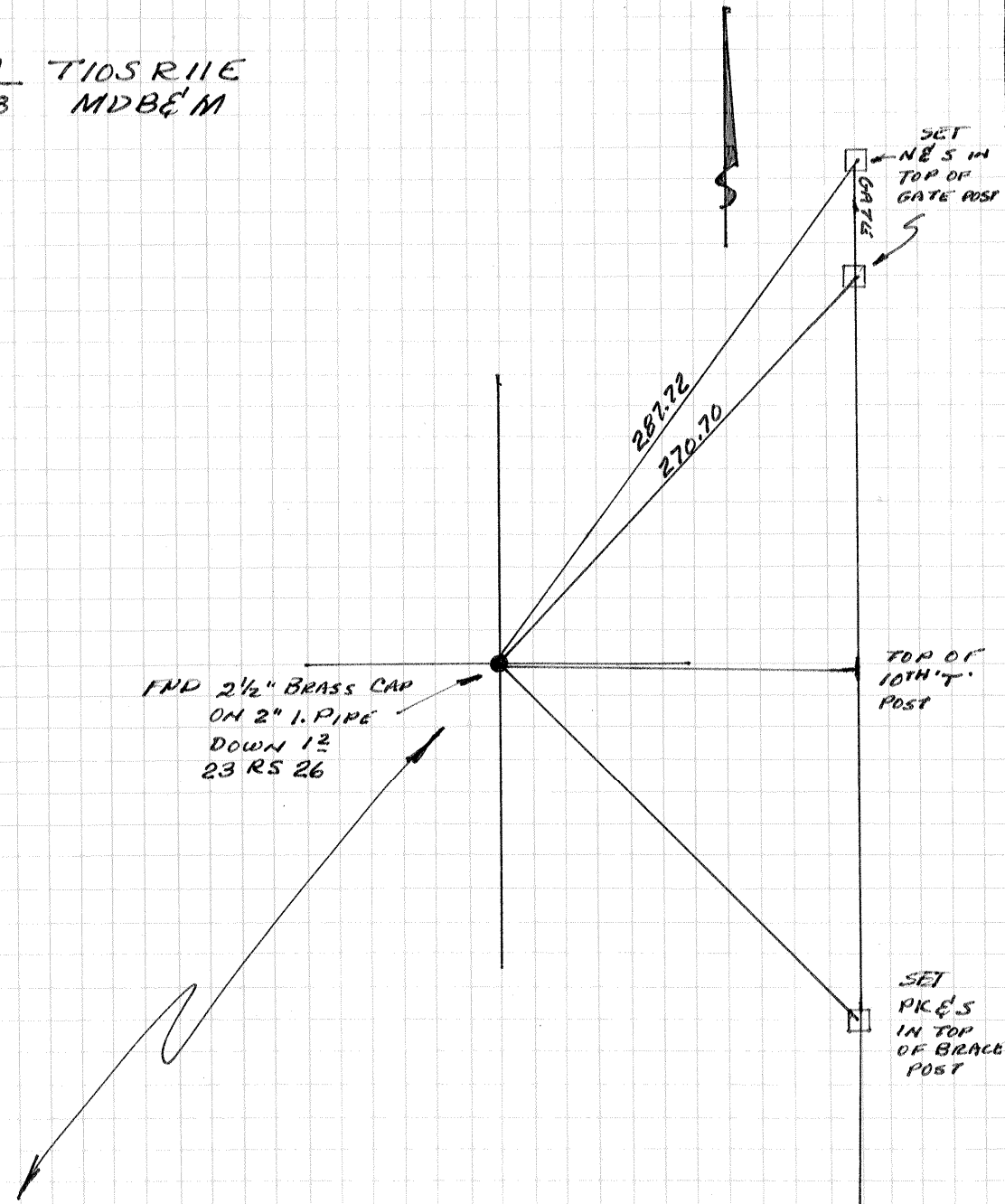

NO. 111111111111
 20 21
 29 28
 U.S. BUREAU OF