

# CORNER RECORD

Document Number 3786-I  
 City of \_\_\_\_\_ County of Merced, California

Brief Legal Description Area near the intersection of Hwy165 and Wolfsen Road of Section 13, T9S, R10E, MDB&M

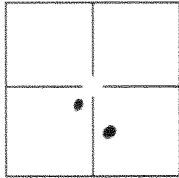

Section 13

### CORNER TYPE

Government Corner  Control   
 Meander  Property   
 Rancho  Other

Date of Survey March 29, 2012

### COORDINATES(Optional)

N. (Pt.3000 - 1876167.42) (PT.3001-1877209.69)  
 E. (Pt.3000 - 6467309.52) (PT.3001-6466781.18)  
 Zone 3 NAD27  NAD83   
 NAD83 Epoch 2002  
 Elev. \_\_\_\_\_  
 Vert. Datum: NGVD29  NADV88   
 Meas. Units: Metric  Imperial

Corner - Left as found  Found and tagged  Established  Reestablished  Rebuilt

Identification and type of corner found: Evidence used to identify or procedure used to establish or reestablish the corner:  
 We tied into the CFL Entrance Road Project Control Points 3000 and 3001 being 2.5" Aluminum Caps. These monument were measured using RTK GPS surveying methods. Bearings, distances, and coordinates for this project are based on the North American Datum of 1983 converted to the California Coordinate System Of 1983 (NAD83), Zone 3, US Survey Feet Units, 2002 epoch date adjustment. All distances and coordinates are grid;  
 A Combined Scale Factor of 1.00001564 should be utilized to convert grid distances to ground distances.

A description of the physical condition of the monument as found and as set or reset: 2.5" Aluminum Cap stamped "FEDERAL HIGHWAY ADMIN. DENVER, COLO. CFLHD" with point number and punch mark in good physical condition from a visual inspection. These monuments are located in the vicinity of Highway 165, Wolfsen Road, San Luis Canal and San Luis Drain. Point 3000 is located on Wolfsen Road at the intersection of San Luis Canal. Point 3001 is located approximately 1300' northerly along Hwy 165 from the intersection of Wolfsen Road and Hwy 165 in the San Luis Canal Right of Way being approx 135' westerly of the centerline of Hwy 165.

### SURVEYOR'S STATEMENT

This Corner Record was prepared by me or under my direction in conformance with the Land Surveyor's Act on October 10, 2012.  
 Signed Brett A. Setness P.L.S. or ~~P.C.E.~~ No.: 8265



### COUNTY SURVEYOR'S STATEMENT

This Corner Record was received October 11, 2012 and examined and filed October 12, 2012.  
 Signed J. Steven Reichmuth P.L.S. or ~~P.C.E.~~ No.: 4895  
 Title Acting County Surveyor  
 County Surveyor's Comment \_\_\_\_\_

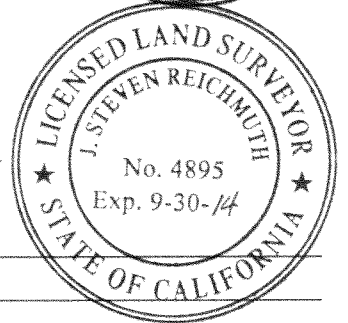

APN: 070-150-043  
STATE OF CALIFORNIA  
FISH & GAME  
WILDLIFE

BEING A PORTION OF SECTION 13  
TOWNSHIP 9 SOUTH,  
RANGE 10 EAST,  
MOUNT DIABLO BASE AND  
MERIDIAN,  
MERCED COUNTY, CALIFORNIA

POINT 3001  
N-1877209.69  
E-6466781.18  
FOUND CFLHD 2.5"  
ALUMINUM CAP

APN: 070-250-017  
STANDARD DUCK CLUB LLC

APN: 070-150-023  
UNITED STATES OF  
AMERICA  
BUREAU OF  
RECLAMATION  
PARCEL M-9 PER  
1787 O.R. 227, M.C.R.

APN: 070-250-018  
WHEEL-BERRY LLC

POINT 3000  
N-1876167.42  
E-6467309.52  
FOUND CFLHD 2.5"  
ALUMINUM CAP

APN: 070-150-012  
STATE OF CALIFORNIA  
FISH & GAME  
WILDLIFE

POINT 41006  
N-1874721.99  
E-6464094.60  
FOUND 3/4" IRON PIN WITH  
YELLOW PLASTIC CAP  
STAMPED "LS 4156"

APN: 070-150-027  
WHEEL-BERRY LLC

FEDERAL HIGHWAY ADMINISTRATION (FHWA)  
CENTRAL FEDERAL LANDS  
HIGHWAY DIVISION PROJECT (CFLHD)  
CA RRP SALU 11(1)

BEARINGS, DISTANCES, AND COORDINATES FOR THIS PROJECT ARE BASED ON THE NORTH AMERICAN DATUM OF 1983 CONVERTED TO THE CALIFORNIA COORDINATE SYSTEM OF 1983 (NAD83), ZONE 3, US SURVEY FEET UNITS, 2002 EPOCH DATE ADJUSTMENT. ALL DISTANCES AND COORDINATES ARE GRID; A COMBINED SCALE FACTOR OF 1.00001564 SHOULD BE UTILIZED TO CONVERT GRID DISTANCES TO GROUND DISTANCES.

ENTRANCE ROAD  
SAN LUIS NATIONAL REFUGE  
WOLFSEN ROAD/HWY 165  
CORNER RECORD

Design BAS	Scale 1"=500'	Date SEPTEMBER 2012
Drawn BAS	Original Drawing Scale 0 1/4" 1/2"	Sheet Number 1 Of 1
Check KFN		Project File No. 2183-0010

**K S N** INC.  
KJELSDEN  
SINNOCK  
NEUDECK  
Civil Engineers  
and Land Surveyors  
711 N. Pershing Avenue  
Stockton, CA 95203-2152  
Office: (209) 946-0268  
Faxes: (209) 946-0296  
E-mail: KSN@ksninc.com

FILE SPEC: P:\2183\_San\_Luis\_NWR\_Entrance\_Road\0010\_Preliminary\_Row\04\_Survey\300\_Boundary\Entrance\_Plan\Cattrans\Corner\_Record.dwg  
PLOT DATE: Oct 10, 2012 10:40am