

CORNER RECORD

Document Number 3773

City of _____ County of MERCED, California

Brief Legal Description N.E. Cor. Sect. 17, T10S R11E M0B6M

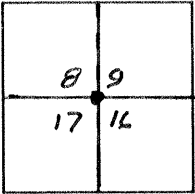

CORNER TYPE

Government Corner Control
 Meander Property
 Rancho Other
 Date of Survey 6-20-90

COORDINATES (Optional)

N. _____
 E. _____
 Zone _____ Datum _____
 Elev. _____

Corner — Left as found Found and tagged Established Reestablished Rebuilt

Identification and type of corner found: Evidence used to identify or procedure used to establish or reestablish the corner: FOUND 2 1/4" I. PIPE PER PREVIOUS TIES BY CALTRANS

A description of the physical condition of the monument as found and as set or reset: MONUMENT IN POOR CONDITION - SET 1" I. PIPE WITH CALTRANS MON. PLUG IN CENTER OF OLD PIPE, DOWN 0.2.

SURVEYOR'S STATEMENT

This Corner Record was prepared by me or under my direction in conformance with the Land Surveyors' Act on JUNE 20 1990.

Signed Ralph N. Scheel, Jr. L.S. or R.C.E. Number LS 3730
 LIC. EXP. 6/30/92

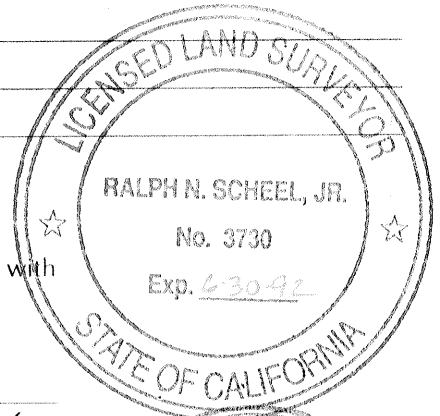

COUNTY SURVEYOR'S STATEMENT

This Corner Record was received August 1990 and examined and filed August 22, 1990.

Signed Roy L. Turney Title Dep. Co. Surveyor



County Surveyor's Comment COR. # 3773

8 9
17 16

TIOSRIE
MOBEM

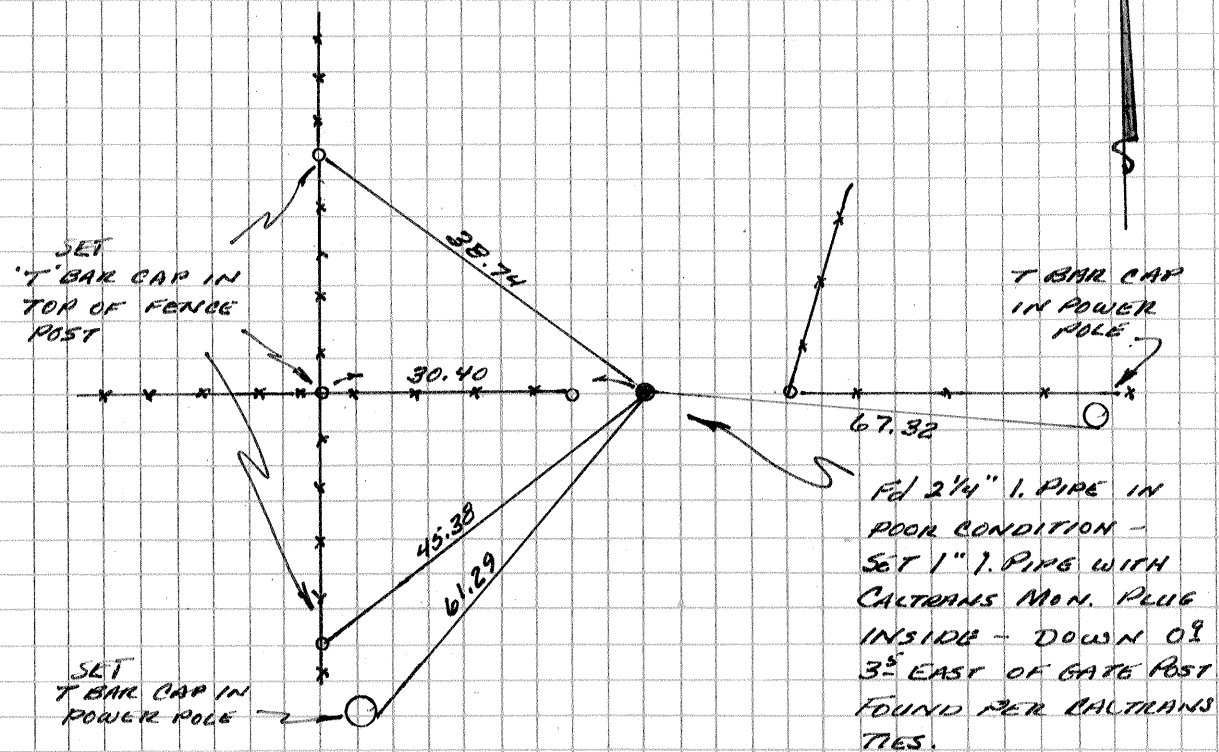

PATTON ROAD