

H 3742

CORNER & RECORD

COUNTY OF Merced T. 9 South R. 10 East Mt. Diablo MERIDIAN CALIFORNIA

CORNER TYPE: GOV'T. CORNER  MEANDER  RANCHO  CONTROL  OTHER

CORNER IDENTIFICATION — DATE OF VISIT January 29 1979



West Quarter Corner

CORNER — LEFT AS FOUND  FOUND AND TAGGED  REESTABLISHED OBLITERATED CORNER  REBUILT

PHYSICAL DESCRIPTION OF CORNER FOUND; EVIDENCE AND METHOD USED TO IDENTIFY OR REESTABLISH

2-1/2" O.D. U.S.B.R. Brass Cap stamped RCE 5905, on 1" O.D. iron pipe @ 0.1 ft. down

PHYSICAL DESCRIPTION OF MONUMENTS REBUILT OR PERPETUATED

CALIFORNIA COORDINATE SYSTEM ORDER: FIRST  SECOND  THIRD   
STATIONS USED: NGS (USC & GS)  STATE  COUNTY  OTHER  STATION \_\_\_\_\_ STATION \_\_\_\_\_  
ZONE \_\_\_\_\_ ELEVATION \_\_\_\_\_ NORTHINGS (Y) \_\_\_\_\_ EASTINGS (X) \_\_\_\_\_

SKETCH: (Include reference tie or witness points, remarks and topo of area)

- 55.54 SOUTH OF NAIL & SHINER IN POWERPOLE
- 26.94 NORTHEAST OF NAIL & SHINER IN FENCE POST
- 64.41 WEST OF NAIL & SHINER IN RAILROAD TIE POST
- 45.15 WEST OF U.S.B.R. TRAIL IN HORIZONTAL BRACE BETWEEN FENCE POSTS

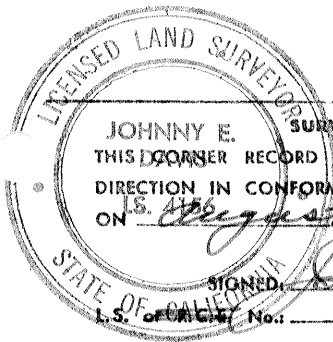
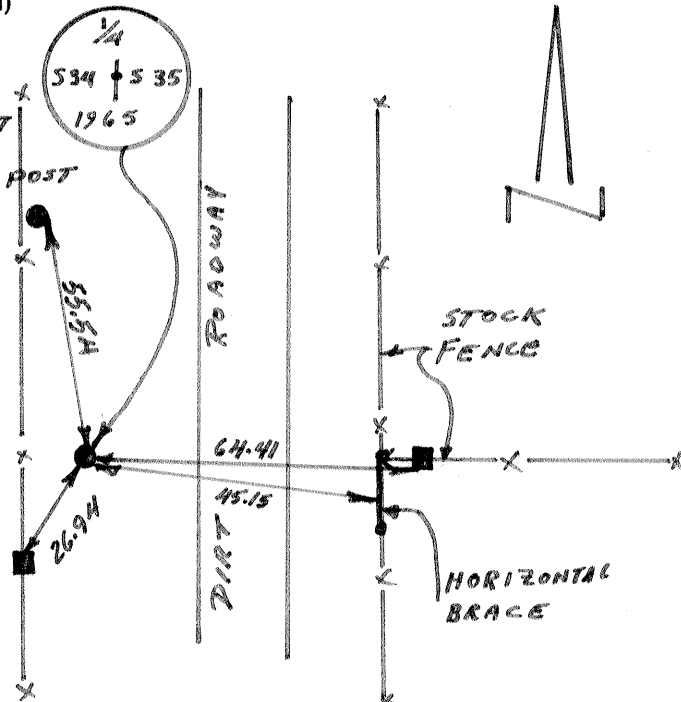

JOHNNY E. SURVEYOR'S CERTIFICATE  
THIS CORNER RECORD WAS PREPARED BY ME OR UNDER MY DIRECTION IN CONFORMANCE WITH THE LAND SURVEYORS ACT ON August 19 1979  
SIGNED: Johnny E. Davis  
L.S. or C.S. No.: 4156

COUNTY SURVEYOR'S CERTIFICATE  
THE CORNER RECORD WAS RECEIVED \_\_\_\_\_ 19\_\_\_\_\_  
AND EXAMINED AND FILED \_\_\_\_\_ 19\_\_\_\_\_  
BY: \_\_\_\_\_  
TITLE: \_\_\_\_\_  
DOCUMENT No. 3742  
STATEMENT ON BACK OF SHEET YES  NO

SEAL