

# 3727

# CORN RECORD

COUNTY OF Merced T. 9S R. 9E MDB& MERIDIAN CALIFORNIA

CORNER TYPE: GOV'T. CORNER  MEANDER  RANCHO  CONTROL  OTHER

CORNER IDENTIFICATION — DATE OF VISIT 12-4 19 74



*CORNER*  
*No 3727*

CORNER — LEFT AS FOUND  FOUND AND TAGGED  REESTABLISHED OBLITERATED CORNER  REBUILT

PHYSICAL DESCRIPTION OF CORNER FOUND; EVIDENCE AND METHOD USED TO IDENTIFY OR REESTABLISH

Fd 1" OD Iron pipe with plastic plug RCE 6888 as shown on Parcel Map Bk 25 Pg 35  
County of Merced

PHYSICAL DESCRIPTION OF MONUMENTS REBUILT OR PERPETUATED

CALIFORNIA COORDINATE SYSTEM ORDER: FIRST  SECOND  THIRD   
STATIONS USED: NGS (USC & GS)  STATE  COUNTY  OTHER  STATION \_\_\_\_\_ STATION \_\_\_\_\_  
ZONE \_\_\_\_\_ ELEVATION \_\_\_\_\_ NORTHINGS (Y) \_\_\_\_\_ EASTINGS (X) \_\_\_\_\_

SKETCH: (Include reference tie or witness points, remarks and topo of area)

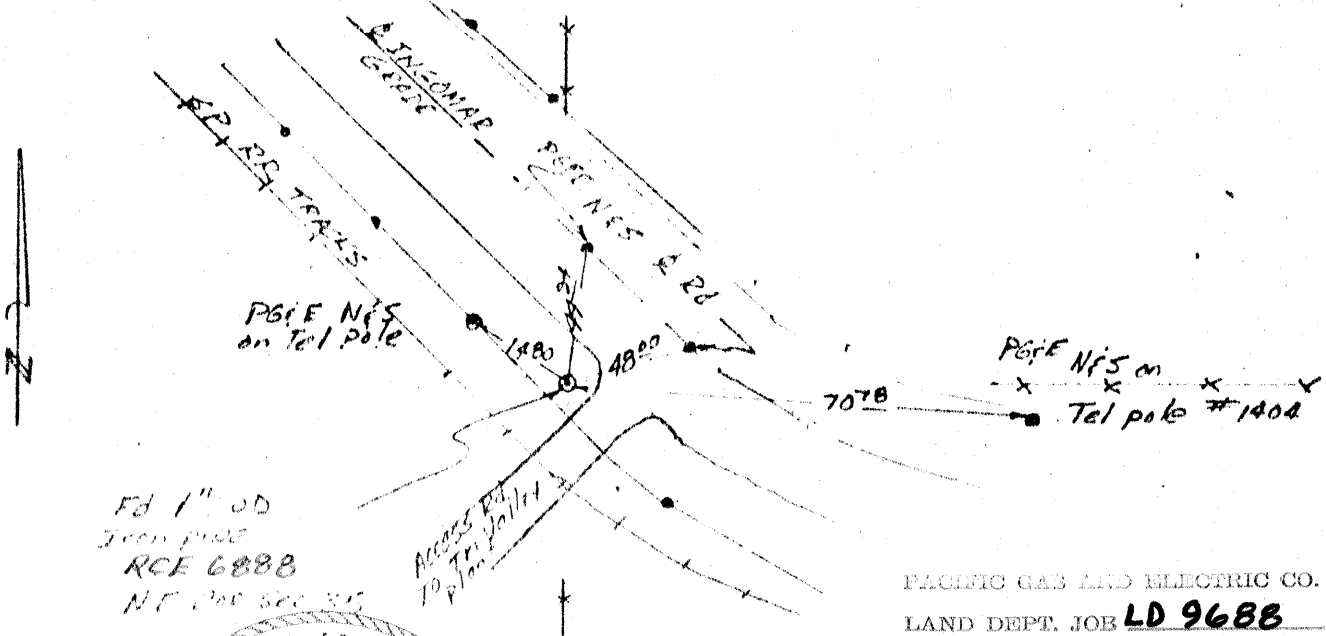

### SURVEYOR'S CERTIFICATE

THIS CORNER RECORD WAS PREPARED BY ME OR UNDER MY DIRECTION IN CONFORMANCE WITH THE LAND SURVEYORS ACT ON 12-4 19 75

SIGNED: \_\_\_\_\_

L.S. or R.C.E. No. LS 2613

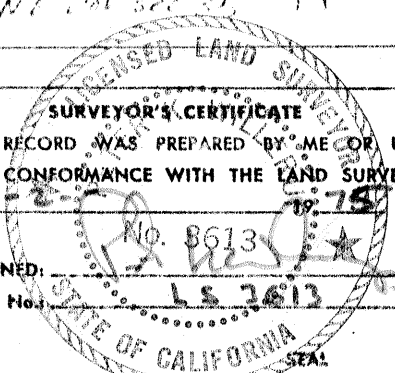

### COUNTY SURVEYOR'S CERTIFICATE

THE CORNER RECORD WAS RECEIVED 2-18 19 75  
AND EXAMINED AND FILED 2-19 19 75

BY: J. W. [Signature]  
TITLE: Co Surveyor

DOCUMENT No. 3727

STATEMENT ON BACK OF SHEET

YES  NO