

CORNER RECORD

Document Number 3709 C

City of _____

County of MERCED, California

Brief Legal Description PROPERTY COR. ALONG SOUTH LINE OF 15 RS 49-MER.CO. REC. IN SEC 26, T. 7 S., R. 11 E., MPM



CORNER TYPE

COORDINATES (Optional)

Government Corner Control
Meander Property
Rancho Other
Date of Survey 2-6-92

N. _____
E. _____
Zone _____ Datum _____
Elev. _____

Corner — Left as found Found and tagged Established Reestablished Rebuilt

Identification and type of corner found: Evidence used to identify or procedure used to establish or reestablish the corner: 1/2" IRON PIPE TAGGED R.C.E. 19256, DOWN 15 IN GOOD CONDITION PER 15 RS 49, MER. CO. REC.

A description of the physical condition of the monument as found and as set or reset: Mon. in Good Condition Down 15

SURVEYOR'S STATEMENT

This Corner Record was prepared by me or under my direction in conformance with the Land Surveyors' Act on 2-6 1992

Signed Ralph Scheel L.S. or R.C.E. Number 3730
License Expiration Date 6-30-92

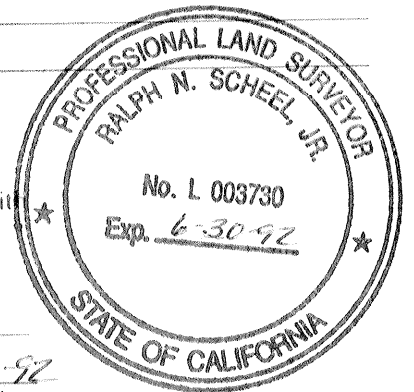

COUNTY SURVEYOR'S STATEMENT

This Corner Record was received 3-13- 1992 and examined and filed 3-20- 1992.

Signed Roy L. Turney Title Dep. Co. Surveyor

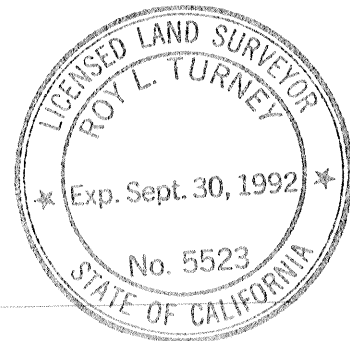

County Surveyor's Comment _____

PROPERTY CORNER ON
SOUTH LINE, 15-RS-A9, MER. CO. REC.

SECT. 26, T. 75., R. 11E., M.D.M.

101.0185
LS2402
LINE

PROPERTY LINE

1/2" IRON PIPE
R.C.E. 19256

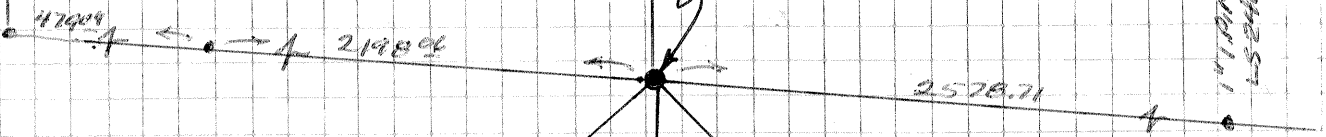

ST. RT. 140

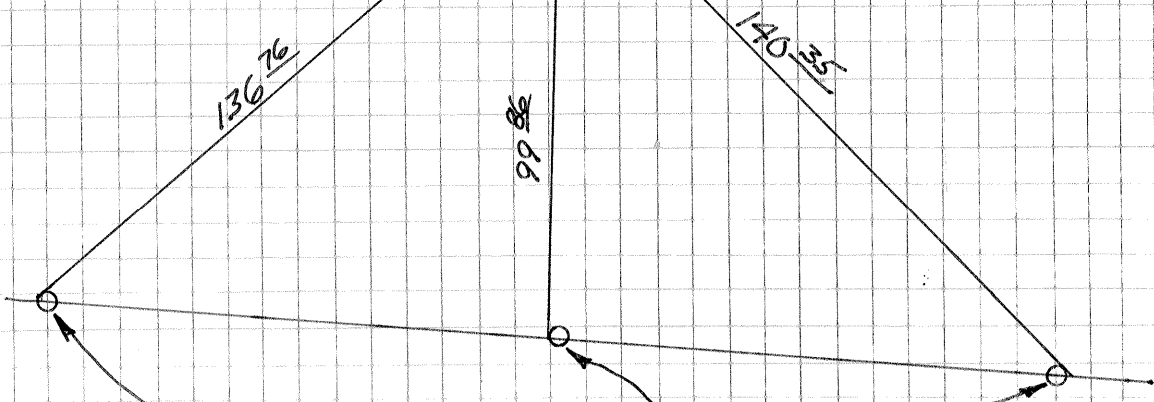

PK'S & SHINER'S
IN WOOD FENCE POSTS



2442.54
171.0185
LINE