

CORNER RECORD

Document Number 36790

City of _____ County of MERCED, California

Brief Legal Description Corners - Lot 5 - The Henry Place 70P.24, M.C.R.

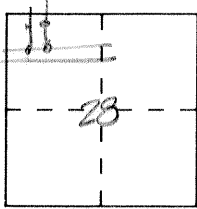

6/11

CORNER TYPE

- Government Corner
- Meander
- Rancho
- Date of Survey _____
- Control
- Property
- Other

COORDINATES (Optional)

N. _____
 E. _____
 Zone _____ Datum _____
 Elev. _____

Corner — Left as found Found and tagged Established Reestablished Rebuilt

Identification and type of corner found: Evidence used to identify or procedure used to establish or reestablish the corner:

See back

A description of the physical condition of the monument as found and as set or reset: _____

See back

SURVEYOR'S STATEMENT

This Corner Record was prepared by me or under my direction in conformance with the Land Surveyors' Act on July 2 19 98.

Signed [Signature] L.S. or R.C.E. Number _____

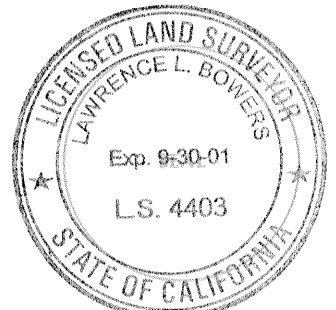

COUNTY SURVEYOR'S STATEMENT

This Corner Record was received 7-6- 19 98 and examined and filed 7-24 19 98.

Signed Roy L. Turney Title Dep. Co. Sur.



County Surveyor's Comment _____

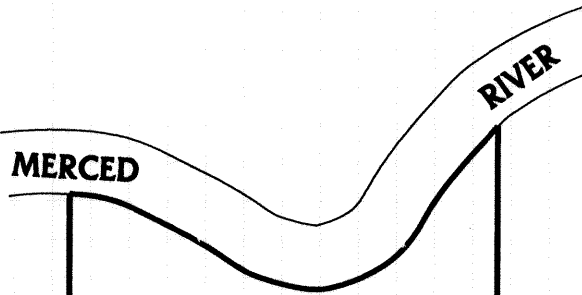
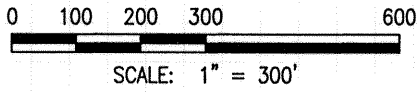
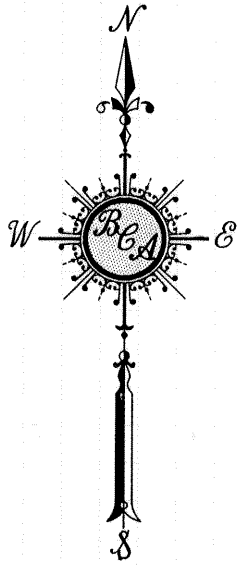

CORNERS FOUND PER W.E.B.
FIELD BOOK 398, PAGE 41

FOUND 3/4" IRON PIPE,
BENT, REPLACED WITH 3/4"
IRON PIPE, L.S. 4403

LOT 6

LOT 5

LOT 4

(1015.87')

(1015.87')

FOUND 3/4" IRON PIPE

(660')

FOUND 4"X4" POST,
ROTTED, SET 3/4" IRON
PIPE, L.S. 4403
THROUGH CENTER

60'

VINEWOOD

AVENUE