

**CORNER RECORD**

Document Number 3650 XX

City of LOS BANOS

County of MERCED, California

Brief Legal Description N.W. COR. INTERSECTION OF CALIFORNIA & PACHECO

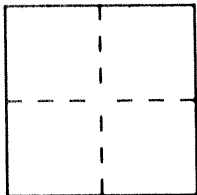

SECT 15  
T105R10E  
MDM

**CORNER TYPE**

Government Corner  Control   
Meander  Property   
Rancho  Other   
Date of Survey 3-12-93

**COORDINATES (Optional)**

N. \_\_\_\_\_  
E. \_\_\_\_\_  
Zone \_\_\_\_\_ Datum \_\_\_\_\_  
Elev. \_\_\_\_\_

Corner — Left as found  Found and tagged  Established  Reestablished  Rebuilt

Identification and type of corner found: Evidence used to identify or procedure used to establish or reestablish the corner: FOUND PLASTIC PLUG (WASHER) WITH SCREW THRU CENTER MARKED R. 25.0 AT OR NEAR N.W. COR. OF INTERSECTION OF CALIFORNIA & PACHECO

A description of the physical condition of the monument as found and as set or reset: MONUMENT APPEARS FAIRLY NEW AND IN GOOD CONDITION — WILL BE DESTROYED BY CONSTRUCTION

**SURVEYOR'S STATEMENT**

This Corner Record was prepared by me or under my direction in conformance with the Land Surveyors' Act on 3-21 1993.

Signed Ralph Scheel L.S. or R.C.E. Number L53730  
PARTY CHIEF, CALTRANS

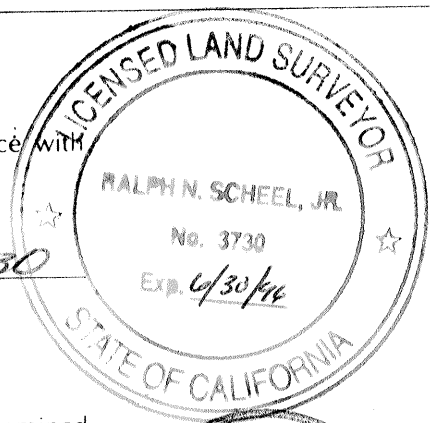

**COUNTY SURVEYOR'S STATEMENT**

This Corner Record was received 2-23- 1994 and examined and filed 2-25 1994.

Signed Roy Turney Title DEP. CO. SUR.

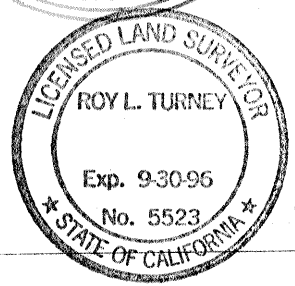

County Surveyor's Comment Found no record of this monument

SECT 15  
7105R10E MDM  
NORTHWEST CORNER  
CALIFORNIA E PACHECO

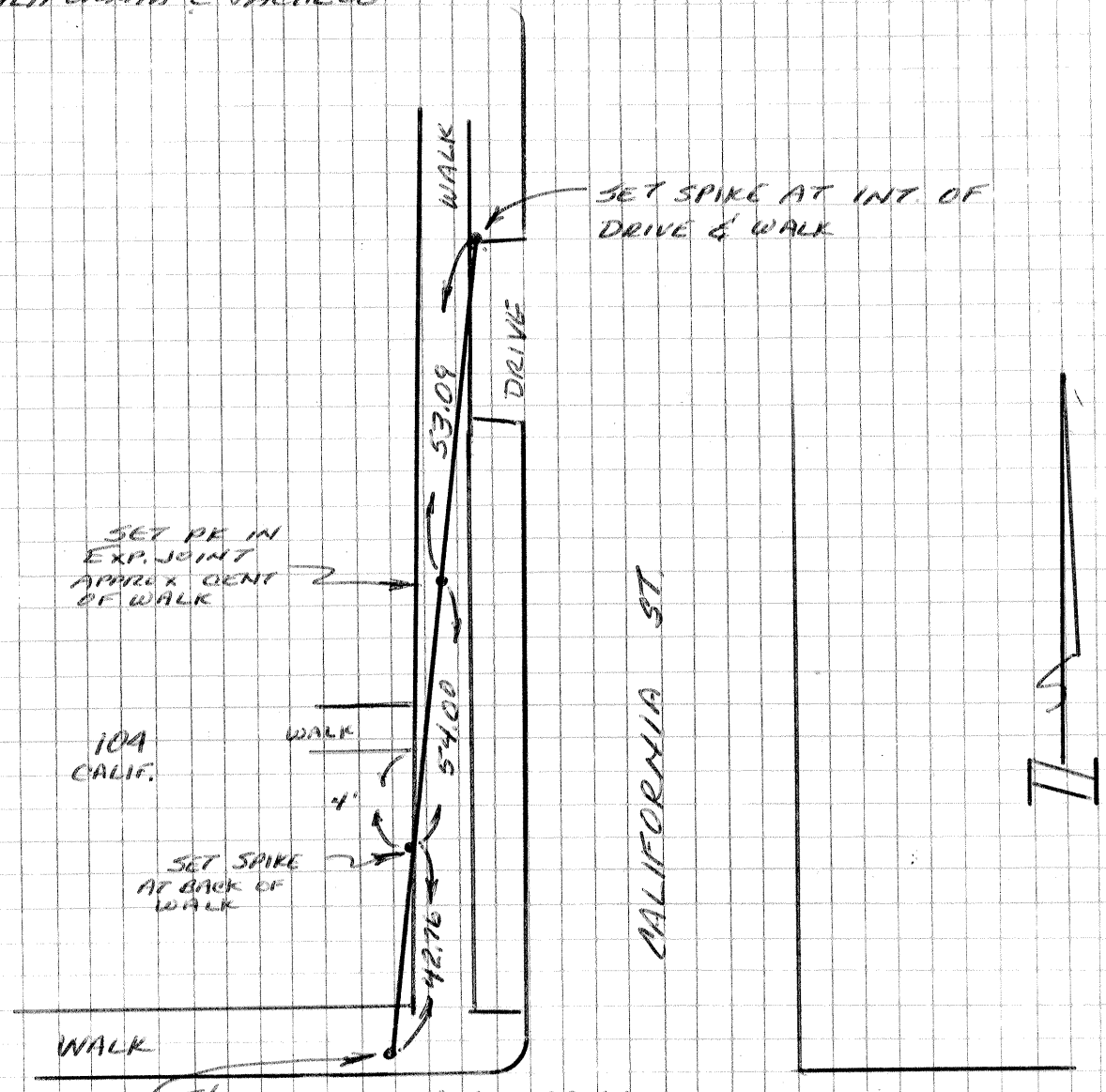

SET PK IN  
EXP. JOINT  
APPROX. CENT.  
OF WALK

SET SPIKE AT INT. OF  
DRIVE & WALK

104  
CALIF.

SET SPIKE  
AT BACK OF  
WALK

FD. PLASTIC CAP WITH SCREW  
IN CENTER MKD R 2500  
IN SURFACE OF WALK

PACHECO BLVD

ST. RT. 152

The ties shown hereon are for the purpose of perpetuating the monumentation currently existing. No attempt was made to determine the validity of the monuments or their proper location in relation to local boundary lines in the area.