

# CORNER RECORD

Document Number 3650-AAA

City of Los Banos

County of Merced, California

Brief Legal Description Lot corner on north side Pacheco Blvd (State Hwy 152) approx. 30 Ft. west of Illinois Ave. centerline, in SEC 15, T10S, R10E, M1M

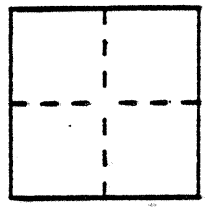

### CORNER TYPE

Government Corner  Control   
 Meander  Property   
 Rancho  Other   
 Date of Survey 3-8-96

### COORDINATES (Optional)

N. 203,010.8  
 E 1,895,647.1  
 Zone 3 Datum 27  
 Elev. \_\_\_\_\_

Corner — Left as found  Found and tagged  Established  Reestablished  Rebuilt

Identification and type of corner found: Evidence used to identify or procedure used to establish or reestablish the corner:  
Found 1 1/2" OD Iron pipe, see 12/09/14 Merced County Records

A description of the physical condition of the monument as found and as set or reset: Good

### SURVEYOR'S STATEMENT

This Corner Record was prepared by me or under my direction in conformance with the Land Surveyors' Act on 3-14 1996.

Signed Patrick D. Gibbs L.S. or R.C.E. Number LS 5665

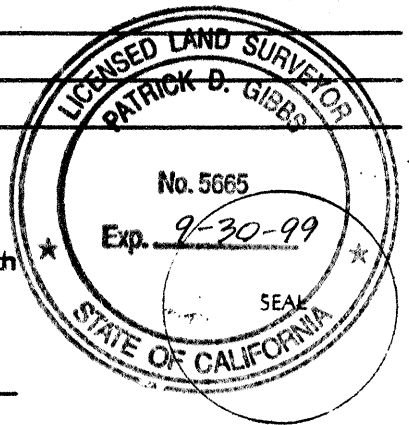

### COUNTY SURVEYOR'S STATEMENT

This Corner Record was received MAY 1996 and examined and filed MAY 22, 1996.

Signed Roy L. Turney Title Dep Co. Sur.

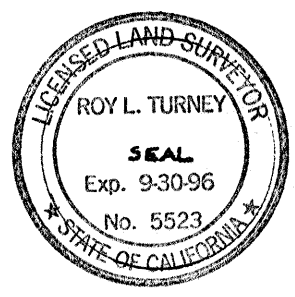

County Surveyor's Comment \_\_\_\_\_



SEC 15, T10S, R10E, MDM

No Scale

P. Giblin 3-14-96

The lines shown herein are for the purpose of perpetuating the monumentation currently existing. No attempt was made to determine the validity of the monuments or their proper location in relation to legal boundary lines in the area.

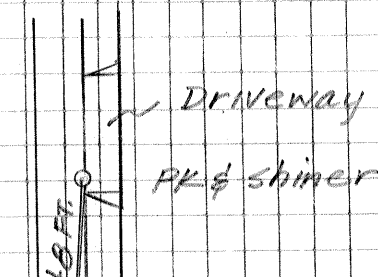

22.14 FT

52.54 FT

20.48 FT

"4" in conc. sidewalk

PK & shiner

Fd 1 1/2" OD Iron pipe  
see 12/OP/14  
Mex. Co. Rec.

+ 30'

+ 30'

ILLINOIS AVE

Gilroy

State Hwy 152

Dos Palos