

# CORNER RECORD

COUNTY OF Merced T. 8 S. R. 15 E. M.D.B. MERIDIAN CALIFORNIA  
 CORNER TYPE: GOVT. CORNER  MEANDER  RANCHO  CONTROL  OTHER   
 CORNER IDENTIFICATION — DATE OF VISIT May 20 19 83

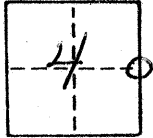

CORNER — LEFT AS FOUND  FOUND AND TAGGED  REESTABLISHED OBLITERATED CORNER  REBUILT

PHYSICAL DESCRIPTION OF CORNER FOUND; EVIDENCE AND METHOD USED TO IDENTIFY OR REESTABLISH  
Found 5/8" iron rod with tag R.C.E. 13760  
Found by using ties in Field book 711 page 15

PHYSICAL DESCRIPTION OF MONUMENTS REBUILT OR PERPETUATED  
Removed 5/8" iron rod; set 1" inside diameter iron pipe  
and tagged "County Surveyor," in survey encasement.

CALIFORNIA COORDINATE SYSTEM ORDER: FIRST  SECOND  THIRD   
 STATIONS USED: NGS (USC & GS)  STATE  COUNTY  OTHER  STATION \_\_\_\_\_ STATION \_\_\_\_\_  
 ZONE \_\_\_\_\_ ELEVATION \_\_\_\_\_ NORTHINGS (Y) \_\_\_\_\_ EASTINGS (X) \_\_\_\_\_

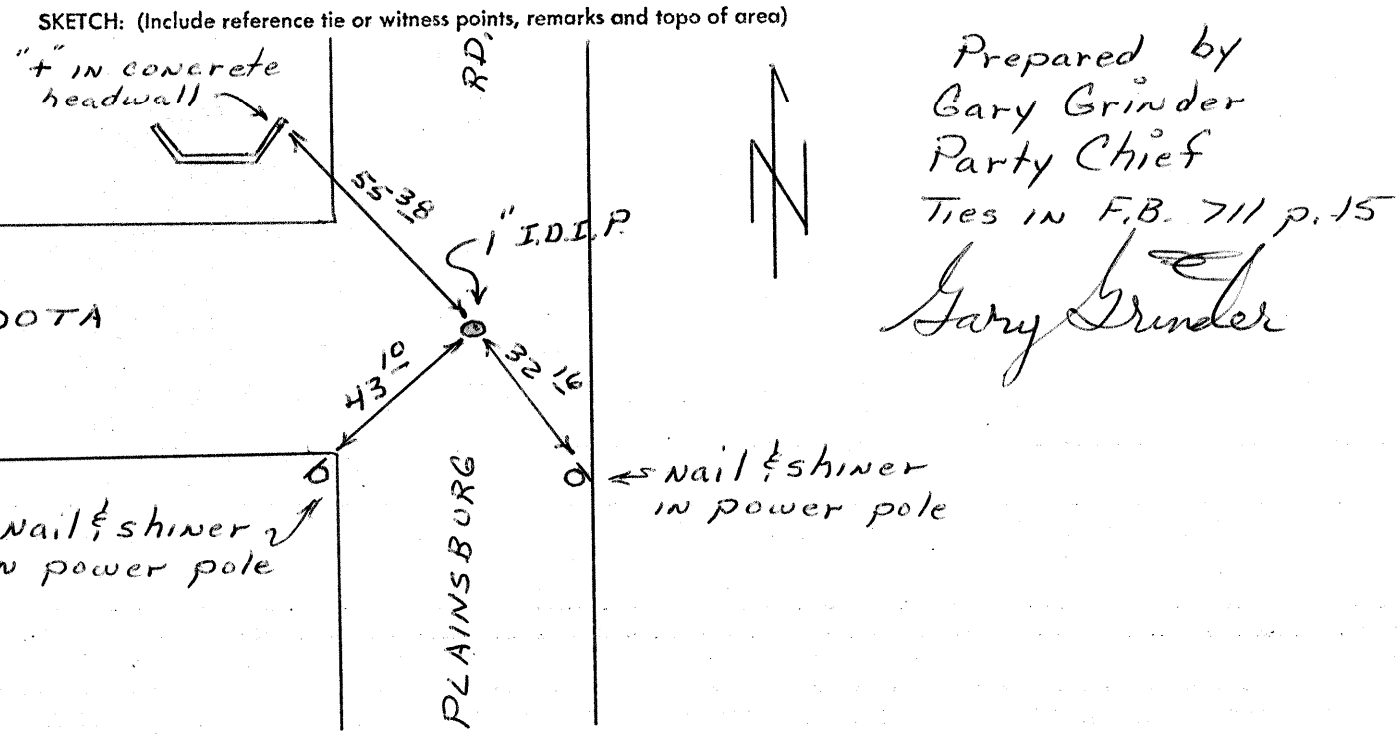

**SURVEYOR'S CERTIFICATE**  
 THIS CORNER RECORD WAS PREPARED BY ME OR UNDER MY DIRECTION IN CONFORMANCE WITH THE LAND SURVEYORS ACT ON \_\_\_\_\_ 19\_\_\_\_\_  
 SIGNED: \_\_\_\_\_  
 L.S. or R.C.E. No.: \_\_\_\_\_  
 SEAL

**COUNTY SURVEYOR'S CERTIFICATE**  
 THE CORNER RECORD WAS RECEIVED \_\_\_\_\_ 19\_\_\_\_\_  
 AND EXAMINED AND FILED \_\_\_\_\_ 19\_\_\_\_\_  
 BY: [Signature]  
 TITLE: County Surveyor  
 DOCUMENT No. 3480  
 STATEMENT ON BACK OF SHEET YES  NO