

NO. 3432

CORNER RECORD

COUNTY OF Merced T 9S R. 15E M.D.B. & M. MERIDIAN CALIFORNIA

CORNER TYPE: GOV'T. CORNER [] MEANDER [] RANCHO [] CONTROL [] OTHER [x]
CORNER IDENTIFICATION - DATE OF VISIT June 3, 1977



Northwest corner of Lot 4, Block 22, (Section 22) as shown on the Map of the Bliss Ranch Subdivision on file in Volume 7 of plats at page 46, M.C.R.

CORNER - LEFT AS FOUND [] FOUND AND TAGGED [x] REESTABLISHED OBLITERATED CORNER [] REBUILT []

PHYSICAL DESCRIPTION OF CORNER FOUND; EVIDENCE AND METHOD USED TO IDENTIFY OR REESTABLISH

Found 3 x 3 redwood post broken off at 1.0 below groundline
Set 1" O.D. pipe with plastic plug marked L.S. 4156 in center of redwood

PHYSICAL DESCRIPTION OF MONUMENTS REBUILT OR PERPETUATED

Offset monument
Set 1" O.D. pipe tagged L.S. 4156 at groundline 17.00 feet west of original corner. Pipe at 180 degrees angle from the north line of the North East 1/4

CALIFORNIA COORDINATE SYSTEM ORDER: FIRST [] SECOND [] THIRD []
STATIONS USED: NGS (USC & GS) [] STATE [] COUNTY [] OTHER [] STATION _____ STATION _____
ZONE _____ ELEVATION _____ NORTHINGS (Y) _____ EASTINGS (X) _____

SKETCH: (Include reference tie or witness points, remarks and topo of area)

Ties to NORTHWEST corner Lot 4.
33.13 Northeast from nail & shiner in power pole
42.26 Southeast from nail & shiner in 4" x 4" fence post

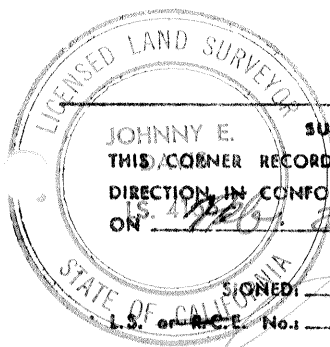

JOHNNY E. SURVEYOR'S CERTIFICATE
THIS CORNER RECORD WAS PREPARED BY ME OR UNDER MY DIRECTION IN CONFORMANCE WITH THE LAND SURVEYORS ACT ON Feb. 27, 1980

SIGNED: [Signature]
L.S. or R.C.E. No.: 1176

SEAL

COUNTY SURVEYOR'S CERTIFICATE

THE CORNER RECORD WAS RECEIVED Feb. 25, 1980 AND EXAMINED AND FILED

BY: Walter Mitchell

TITLE: _____

DOCUMENT No. 3432

STATEMENT ON BACK OF SHEET

YES [] NO []