

3431

CC IER RECORD

COUNTY OF Merced T. 9 S R. 15 E Mt. Diablo MERIDIAN CALIFORNIA

CORNER TYPE: GOVT. CORNER [] MEANDER [] RANCHO [] CONTROL [] OTHER [X]

CORNER IDENTIFICATION — DATE OF VISIT April 21, 1976

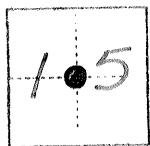

Northwest corner of Lot 20, Block 15 (Section 15) of the Bliss Ranch Subdivision on file in Volume 7 of plats at page 39, M.C.R.

CORNER — LEFT AS FOUND [X] FOUND AND TAGGED [] REESTABLISHED OBLITERATED CORNER [] REBUILT []

PHYSICAL DESCRIPTION OF CORNER FOUND; EVIDENCE AND METHOD USED TO IDENTIFY OR REESTABLISH

Found 4" x 4" redwood with 60^D nail in center 0.8 below ground line.

PHYSICAL DESCRIPTION OF MONUMENTS REBUILT OR PERPETUATED

CALIFORNIA COORDINATE SYSTEM ORDER: FIRST [] SECOND [] THIRD [] STATIONS USED: NGS (USC & GS) [] STATE [] COUNTY [] OTHER [] STATION _____ STATION _____ ZONE _____ ELEVATION _____ NORTHINGS (Y) _____ EASTINGS (X) _____

SKETCH: (Include reference tie or witness points, remarks and topo of area)

53.23 Northeast from nail & shiner in railroad tie.
34.28 Northeast from nail & shiner in railroad tie.
9.57 East from nail & shiner in 4" x 4" post.

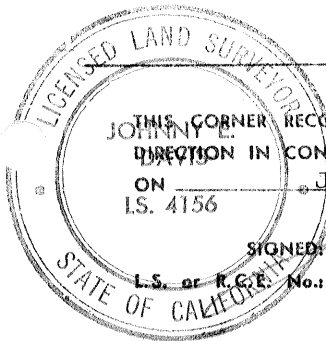

SURVEYOR'S CERTIFICATE

THIS CORNER RECORD WAS PREPARED BY ME OR UNDER MY DIRECTION IN CONFORMANCE WITH THE LAND SURVEYORS ACT ON January 29, 1979 I.S. 4156

SIGNED: [Signature] L.S. or R.C.E. No.: 4156

SEAL

COUNTY SURVEYOR'S CERTIFICATE

THE CORNER RECORD WAS RECEIVED _____ 19____ AND EXAMINED AND FILED _____ 19____

BY: _____ TITLE: _____

DOCUMENT No. 3431

STATEMENT ON BACK OF SHEET YES [] NO []