

NO. 3430

CORNER RECORD

COUNTY OF Merced T. 9S R. 15E Mt. Diablo MERIDIAN CALIFORNIA

CORNER TYPE: GOV'T. CORNER [X] MEANDER [] RANCHO [] CONTROL [] OTHER []

CORNER IDENTIFICATION - DATE OF VISIT April 5, 1977

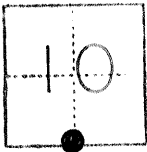

South 1/4 corner Section 10

CORNER - LEFT AS FOUND [X] FOUND AND TAGGED [] REESTABLISHED OBLITERATED CORNER [] REBUILT []

PHYSICAL DESCRIPTION OF CORNER FOUND; EVIDENCE AND METHOD USED TO IDENTIFY OR REESTABLISH

Found 5/8" rebar with aluminum cap at 1.0 below groundline AND 29.99 EASTERLY OF THE N.W. CORNER OF LOT 4, BLOCK 15, BUSS RANCH SUBDIVISION.

PHYSICAL DESCRIPTION OF MONUMENTS REBUILT OR PERPETUATED

Offset Monument Set 1" O.D. iron pipe at groundline with plug L.S. 4156 30 feet south of original corner at 90° angle to south line of the southeast quarter of Section 10.

CALIFORNIA COORDINATE SYSTEM ORDER: FIRST [] SECOND [] THIRD [] STATIONS USED: NGS (USC & GS) [] STATE [] COUNTY [] OTHER [] STATION _____ ELEVATION _____ NORTHINGS (Y) _____ EASTINGS (X) _____

SKETCH: (Include reference tie or witness points, remarks and topo of area)

Ties to southerly offset monument 101.89 Northeast from scribed "X" on north side of 36" standpipe 108.93 Northeast from scribed "X" on north side of 8" air valve 83.66 East from nail & shiner in power pole with 3 transformers 29.81 East from 2-1/2" x 3-1/2" redwood.

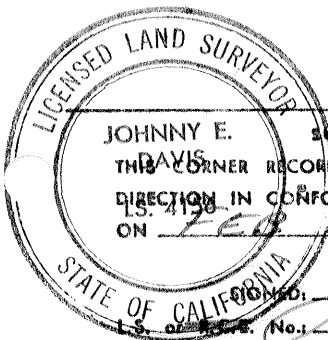

JOHNNY E. DAVIS SURVEYOR'S CERTIFICATE THIS CORNER RECORD WAS PREPARED BY ME OR UNDER MY DIRECTION IN CONFORMANCE WITH THE LAND SURVEYORS ACT ON FEB 29 1989

COUNTY SURVEYOR'S CERTIFICATE THE CORNER RECORD WAS RECEIVED Feb 25 1980 AND EXAMINED AND FILED BY: Walter Mitchell TITLE: DOCUMENT No. 3430 STATEMENT ON BACK OF SHEET YES [] NO []