

3426

CO' ER RECORD

COUNTY OF Merced T. 9 S R. 15 E Mt. Diablo MERIDIAN CALIFORNIA

CORNER TYPE: GOV'T. CORNER [] MEANDER [] RANCHO [] CONTROL [] OTHER [X]

CORNER IDENTIFICATION — DATE OF VISIT June 3, 19 77

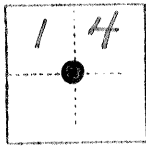

Center 1/4 corner Section 14.

CORNER — LEFT AS FOUND [] FOUND AND TAGGED [] REESTABLISHED OBLITERATED CORNER [X] REBUILT []

PHYSICAL DESCRIPTION OF CORNER FOUND; EVIDENCE AND METHOD USED TO IDENTIFY OR REESTABLISH

Set by intersection of Mid-Section lines.

PHYSICAL DESCRIPTION OF MONUMENTS REBUILT OR PERPETUATED

Set 1" O.D. iron pipe with plug L.S. 4156 0.5 below ground line.

CALIFORNIA COORDINATE SYSTEM ORDER: FIRST [] SECOND [] THIRD [] STATIONS USED: NGS (USC & GS) [] STATE [] COUNTY [] OTHER [] STATION _____ STATION _____ ZONE _____ ELEVATION _____ NORTHINGS (Y) _____ EASTINGS (X) _____

SKETCH: (Include reference tie or witness points, remarks and topo of area)

- 31.55 North from "X" on 8" standpipe.
- 20.04 South from South edge of 16" irrigation valve.
- 26.5 West from centerline of North/South power line.

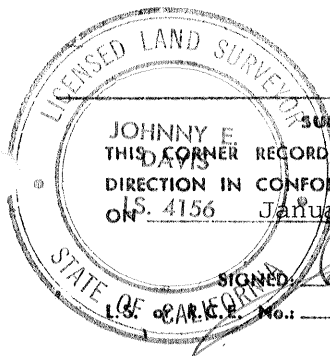

SURVEYOR'S CERTIFICATE

JOHNNY E. DAVIS THIS CORNER RECORD WAS PREPARED BY ME OR UNDER MY DIRECTION IN CONFORMANCE WITH THE LAND SURVEYORS ACT ON S. 4156 January 29, 19 79

SIGNED

L.S. No.: 4156

SEAL

COUNTY SURVEYOR'S CERTIFICATE

THE CORNER RECORD WAS RECEIVED _____ 19 _____ AND EXAMINED AND FILED _____ 19 _____

BY: _____

TITLE: _____

DOCUMENT No. 3426

STATEMENT ON BACK OF SHEET

YES [] NO []