

3426 7A

CORNER RECORD

COUNTY OF Merced T. 9 S R. 15 E Mt. Diablo MERIDIAN CALIFORNIA

CORNER TYPE: GOV'T. CORNER [] MEANDER [] RANCHO [] CONTROL [] OTHER [X]
CORNER IDENTIFICATION - DATE OF VISIT June 3, 1977

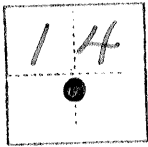

Property corner 272.72 South of the center 1/4 corner Section 14.

CORNER - LEFT AS FOUND [] FOUND AND TAGGED [] REESTABLISHED OBLITERATED CORNER [] REBUILT [X]

PHYSICAL DESCRIPTION OF CORNER FOUND; EVIDENCE AND METHOD USED TO IDENTIFY OR REESTABLISH

PHYSICAL DESCRIPTION OF MONUMENTS REBUILT OR PERPETUATED

Set 1" O.D. pipe with plastic plug marked L.S. 4156 at 0.5 below ground line.

CALIFORNIA COORDINATE SYSTEM ORDER: FIRST [] SECOND [] THIRD []
STATIONS USED: NGS (USC & GS) [] STATE [] COUNTY [] OTHER [] STATION _____
ZONE _____ ELEVATION _____ NORTHINGS (Y) _____ EASTINGS (X) _____

SKETCH: (Include reference tie or witness points, remarks and topo of area)

52.17 East from nail & shiner in telephone post.
28.90 West from nail & shiner in power pole.

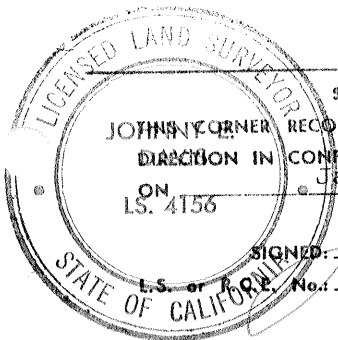

SURVEYOR'S CERTIFICATE

THIS CORNER RECORD WAS PREPARED BY ME OR UNDER MY DIRECTION IN CONFORMANCE WITH THE LAND SURVEYORS ACT ON January 29, 1977 L.S. 4156 SIGNED: [Signature] L.S. or P.L.S. No. 4156

SEAL

COUNTY SURVEYOR'S CERTIFICATE

THE CORNER RECORD WAS RECEIVED _____ 19____ AND EXAMINED AND FILED _____ 19____ BY: _____ TITLE: _____ DOCUMENT No. 3426A STATEMENT ON BACK OF SHEET YES [] NO []