

3417A

CO ER RECORD

COUNTY OF Merced T. 9 S R. 15 E Mt. Diablo MERIDIAN CALIFORNIA

CORNER TYPE: GOV'T. CORNER [] MEANDER [] RANCHO [] CONTROL [] OTHER [x]

CORNER IDENTIFICATION -- DATE OF VISIT April 21, 19 76



Northwest corner lot 9, Block 29 (Section 29) as shown on the Map of the Bliss Ranch Subdivision on file in Volume 7 of Plats page 47 M.C.R.

CORNER -- LEFT AS FOUND [] FOUND AND TAGGED [x] REESTABLISHED OBLITERATED CORNER [] REBUILT []

PHYSICAL DESCRIPTION OF CORNER FOUND; EVIDENCE AND METHOD USED TO IDENTIFY OR REESTABLISH

Found 4 x 4 redwood at 1.90 below road surface. Set 2 x 2 jib with nail at road surface.

PHYSICAL DESCRIPTION OF MONUMENTS REBUILT OR PERPETUATED

CALIFORNIA COORDINATE SYSTEM ORDER: FIRST [] SECOND [] THIRD [] STATIONS USED: NGS (USC & GS) [] STATE [] COUNTY [] OTHER [] STATION _____ STATION _____ ZONE _____ ELEVATION _____ NORTHINGS (Y) _____ EASTINGS (X) _____

SKETCH: (Include reference tie or witness points, remarks and topo of area)

- 59.00 Southeast from nail & shiner in 4 x 4 guard post.
29.22 East from nail & shiner in 6 x 6 fence post.
18.36 West from nail & shiner in railroad tie fence post.

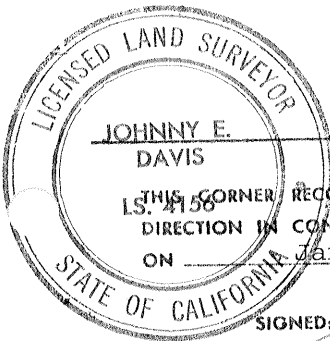

JOHNNY E. DAVIS

SURVEYOR'S CERTIFICATE

THIS CORNER RECORD WAS PREPARED BY ME OR UNDER MY DIRECTION IN CONFORMANCE WITH THE LAND SURVEYORS ACT ON January 29, 19 79

SIGNED: [Signature]

L.S. or R.C.E. No.: 4156

SEAL

COUNTY SURVEYOR'S CERTIFICATE

THE CORNER RECORD WAS RECEIVED _____ 19 _____ AND EXAMINED AND FILED _____ 19 _____

BY: _____

TITLE: _____

DOCUMENT No. 3417A

STATEMENT ON BACK OF SHEET

YES [] NO []