

# 3417

CO ER RECORD

COUNTY OF Merced T. 9 S R. 15 E Mt. Diablo MERIDIAN CALIFORNIA

CORNER TYPE: GOV'T. CORNER [X] MEANDER [ ] RANCHO [ ] CONTROL [ ] OTHER [ ]  
CORNER IDENTIFICATION -- DATE OF VISIT March 19, 19 76



Northwest corner of Block 29 (Section 29) as shown on the Map of the Bliss Ranch Subdivision on file in Volume 7 of Plats at page 47 M.C.R.

CORNER -- LEFT AS FOUND [X] FOUND AND TAGGED [ ] REESTABLISHED OBLITERATED CORNER [ ] REBUILT [ ]

PHYSICAL DESCRIPTION OF CORNER FOUND; EVIDENCE AND METHOD USED TO IDENTIFY OR REESTABLISH

Found 2-1/2" O.D. iron pipe with 2" x 2" hub in center tagged R.C.E. 13760 at 0<sup>4</sup> below road surface in handhole.

PHYSICAL DESCRIPTION OF MONUMENTS REBUILT OR PERPETUATED

CALIFORNIA COORDINATE SYSTEM ORDER: FIRST [ ] SECOND [ ] THIRD [ ]  
STATIONS USED: NGS (USC & GS) [ ] STATE [ ] COUNTY [ ] OTHER [ ] STATION \_\_\_\_\_ STATION \_\_\_\_\_  
ZONE \_\_\_\_\_ ELEVATION \_\_\_\_\_ NORTHINGS (Y) \_\_\_\_\_ EASTINGS (X) \_\_\_\_\_

SKETCH: (Include reference tie or witness points, remarks and topo of area)

39.50 Southeast from nail & shiner in power pole.  
41.92 Northeast from nail & shiner in power pole.

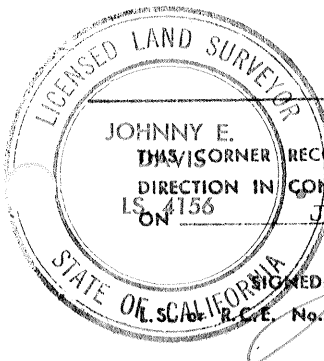

JOHNNY E. DAVIS SURVEYOR'S CERTIFICATE  
THIS CORNER RECORD WAS PREPARED BY ME OR UNDER MY DIRECTION IN CONFORMANCE WITH THE LAND SURVEYORS ACT  
LS 4156 ON January 29, 19 79  
SIGNED: *Johnny E. Davis*  
L.S. No. R.C.E. No. 4156

SEAL

COUNTY SURVEYOR'S CERTIFICATE

THE CORNER RECORD WAS RECEIVED \_\_\_\_\_ 19 \_\_\_\_  
AND EXAMINED AND FILED \_\_\_\_\_ 19 \_\_\_\_  
BY: \_\_\_\_\_  
TITLE: \_\_\_\_\_  
DOCUMENT No. 3417  
STATEMENT ON BACK OF SHEET

YES [ ] NO [ ]