

3411

CORNER RECORD

COUNTY OF Merced T 9 S R 15 E Mt. Diablo MERIDIAN CALIFORNIA

CORNER TYPE: GOV'T. CORNER [] MEANDER [] RANCHO [] CONTROL [] OTHER [x]

CORNER IDENTIFICATION -- DATE OF VISIT May 26, 19 77



Northwest Corner of Lot 4, Block 21 (Section 21) of the Bliss Ranch Subdivision on file in Volume 7 of plats at page 46 of M.C.R.

CORNER -- LEFT AS FOUND [x] FOUND AND TAGGED [] REESTABLISHED OBLITERATED CORNER [] REBUILT []

PHYSICAL DESCRIPTION OF CORNER FOUND; EVIDENCE AND METHOD USED TO IDENTIFY OR REESTABLISH

Found 4" x 4" redwood with 5/8 rod in center 0.6 below ground line, set plastic plug marked L.S. 4156 on 5/8 rod.

PHYSICAL DESCRIPTION OF MONUMENTS REBUILT OR PERPETUATED

CALIFORNIA COORDINATE SYSTEM ORDER: FIRST [] SECOND [] THIRD [] STATIONS USED: NGS (USC & GS) [] STATE [] COUNTY [] OTHER [] STATION EASTINGS (X) STATION

SKETCH: (Include reference tie or witness points, remarks and topo of area)

44.88 South from nail & shiner in railroad tie gate post.
19.34 North from nail & shiner in railroad fence post.
65.11 Northwest from nail & shiner in telephone pole.

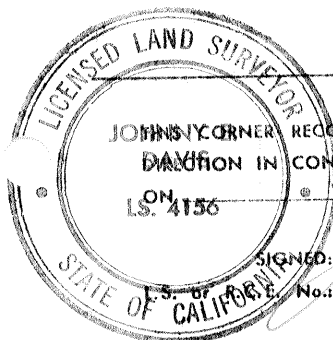

SURVEYOR'S CERTIFICATE

RECORD WAS PREPARED BY ME OR UNDER MY AUTHORITY IN CONFORMANCE WITH THE LAND SURVEYORS ACT ON January 30, 19 79

SIGNED: John C. Davis No.: 4156

SEAL

COUNTY SURVEYOR'S CERTIFICATE

THE CORNER RECORD WAS RECEIVED 19 AND EXAMINED AND FILED 19

BY: TITLE:

DOCUMENT No. 3411

STATEMENT ON BACK OF SHEET

YES [] NO []