

#3409

CO ER RECORD

COUNTY OF Merced T. 9 S R. 15 E Mt. Diablo MERIDIAN CALIFORNIA

CORNER TYPE: GOV'T. CORNER [] MEANDER [] RANCHO [] CONTROL [] OTHER [X]

CORNER IDENTIFICATION — DATE OF VISIT April 14, 19 76

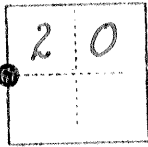

Northwest corner of Lot 24, Block 20 (Section 20) of the Bliss Ranch Subdivision on file in Volume 7 of plats at page 45 of M.C.R.

CORNER — LEFT AS FOUND [X] FOUND AND TAGGED [] REESTABLISHED OBLITERATED CORNER [] REBUILT []

PHYSICAL DESCRIPTION OF CORNER FOUND; EVIDENCE AND METHOD USED TO IDENTIFY OR REESTABLISH

Found 4" x 4" redwood with 1" O.D. pipe set in center, with plug L.S. 3733 1.0 below ground line.

PHYSICAL DESCRIPTION OF MONUMENTS REBUILT OR PERPETUATED

CALIFORNIA COORDINATE SYSTEM ORDER: FIRST [] SECOND [] THIRD [] STATIONS USED: NGS (USC & GS) [] STATE [] COUNTY [] OTHER [] STATION EASTINGS (X) STATION

SKETCH: (Include reference tie or witness points, remarks and topo of area)

31.90 East from nail & shiner in railroad tie fence post. 30.57 West from nail & shiner in 4" x 4" fence post.

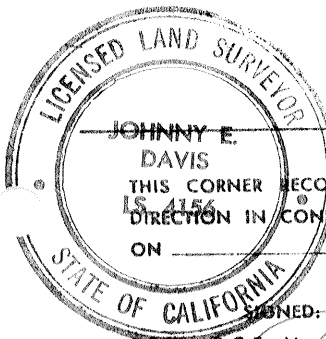

SURVEYOR'S CERTIFICATE THIS CORNER RECORD WAS PREPARED BY ME OR UNDER MY DIRECTION IN CONFORMANCE WITH THE LAND SURVEYORS ACT ON January 30, 19 79 SIGNED: [Signature] L.S. OF R.C.E. No. 4156

SEAL

COUNTY SURVEYOR'S CERTIFICATE

THE CORNER RECORD WAS RECEIVED AND EXAMINED AND FILED BY: TITLE:

DOCUMENT No. 3409

STATEMENT ON BACK OF SHEET

YES [] NO []