

# 3402

# CORNER RECORD

COUNTY OF Merced T. 9 S R. 14 E Mt. Diablo MERIDIAN CALIFORNIA  
 CORNER TYPE: GOV'T. CORNER  MEANDER  RANCHO  CONTROL  OTHER   
 CORNER IDENTIFICATION — DATE OF VISIT March 29, 19 76



Northwest Corner of Lot 4, Block 35 (Section 35) as shown on the Map of the Bliss Ranch Subdivision on file in Volume 7 of plats at page 48, M.C.R.

CORNER — LEFT AS FOUND  FOUND AND TAGGED  REESTABLISHED OBLITERATED CORNER  REBUILT

PHYSICAL DESCRIPTION OF CORNER FOUND; EVIDENCE AND METHOD USED TO IDENTIFY OR REESTABLISH

Found 3" x 3" redwood with 60<sup>D</sup> nail in center.  
 Set plug L.S. 4156 on nail 1.4 below ground.

PHYSICAL DESCRIPTION OF MONUMENTS REBUILT OR PERPETUATED

CALIFORNIA COORDINATE SYSTEM ORDER: FIRST  SECOND  THIRD   
 STATIONS USED: NGS (USC & GS)  STATE  COUNTY  OTHER  STATION \_\_\_\_\_ STATION \_\_\_\_\_  
 ZONE \_\_\_\_\_ ELEVATION \_\_\_\_\_ NORTHINGS (Y) \_\_\_\_\_ EASTINGS (X) \_\_\_\_\_

SKETCH: (Include reference tie or witness points, remarks and topo of area)

- 39.62 Northwest from nail & shiner in telephone pole.
- 37.69 Northeast from nail & shiner in railroad tie.
- 40.23 Southeast from nail & shiner in power pole.

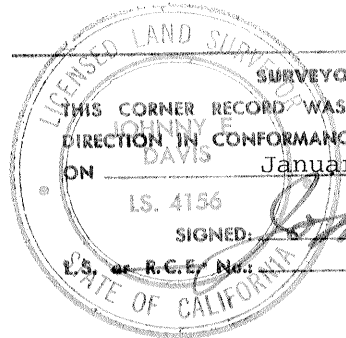

**SURVEYOR'S CERTIFICATE**  
 THIS CORNER RECORD WAS PREPARED BY ME OR UNDER MY DIRECTION IN CONFORMANCE WITH THE LAND SURVEYORS ACT ON January 31, 19 79  
 I.S. 4156  
 SIGNED: [Signature]  
 L.S. or R.C.E. No. 4156

SEAL

**COUNTY SURVEYOR'S CERTIFICATE**

THE CORNER RECORD WAS RECEIVED \_\_\_\_\_ 19\_\_\_\_\_  
 AND EXAMINED AND FILED \_\_\_\_\_ 19\_\_\_\_\_  
 BY: \_\_\_\_\_  
 TITLE: \_\_\_\_\_  
 DOCUMENT No. 3402  
 STATEMENT ON BACK OF SHEET YES  NO