

3398

CORNER RECORD

COUNTY OF Merced T. 9 S R. 15 E Mt. Diablo MERIDIAN CALIFORNIA

CORNER TYPE: GOV'T. CORNER [X] MEANDER [] RANCHO [] CONTROL [] OTHER []
CORNER IDENTIFICATION -- DATE OF VISIT March 19, 1976



Northwest Corner of the Bliss Ranch Subdivision filed in Volume 7 of Plats at Page 47, M.C.R. Block 30 (Section 30)

CORNER -- LEFT AS FOUND [] FOUND AND TAGGED [X] REESTABLISHED OBLITERATED CORNER [] REBUILT []

PHYSICAL DESCRIPTION OF CORNER FOUND; EVIDENCE AND METHOD USED TO IDENTIFY OR REESTABLISH

Found 1 1/2" O.D. pipe with redwood plug 1.8 below road surface.

PHYSICAL DESCRIPTION OF MONUMENTS REBUILT OR PERPETUATED

CALIFORNIA COORDINATE SYSTEM ORDER: FIRST [] SECOND [] THIRD []
STATIONS USED: NGS (USC & GS) [] STATE [] COUNTY [] OTHER [] STATION _____ STATION _____
ZONE _____ ELEVATION _____ NORTHINGS (Y) _____ EASTINGS (X) _____

SKETCH: (Include reference tie or witness points, remarks and topo of area)

- 38.92 Southeast from nail & shiner in power pole.
- 39.53 Northeast from nail & shiner in power pole.
- 35.33 Northwest from nail & shiner in railroad tie.

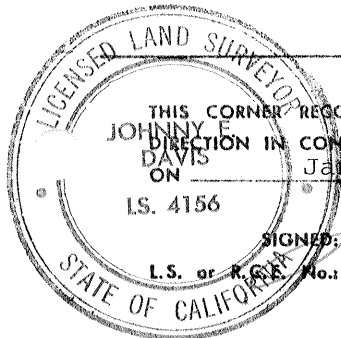

SURVEYOR'S CERTIFICATE

THIS CORNER RECORD WAS PREPARED BY ME OR UNDER MY DIRECTION IN CONFORMANCE WITH THE LAND SURVEYORS ACT ON January 29, 1979

L.S. 4156

SIGNED: *Johnny E. Davis*

4156

L.S. or R.S. No.:

SEAL

COUNTY SURVEYOR'S CERTIFICATE

THE CORNER RECORD WAS RECEIVED _____ 19____ AND EXAMINED AND FILED _____ 19____

BY: _____

TITLE: _____

DOCUMENT No. 3398

STATEMENT ON BACK OF SHEET

YES []

NO []