

3396

CORNER RECORD

COUNTY OF Merced T 9 S R 14 E Mt. Diablo MERIDIAN CALIFORNIA

CORNER TYPE: GOVT. CORNER [X] MEANDER [] RANCHO [] CONTROL [] OTHER []

CORNER IDENTIFICATION — DATE OF VISIT March 18, 19 76



Northwest corner, Block 25 (Section 25) as shown on the Map of the Bliss Ranch Subdivision on file in Volume 7 of plats at page 48, M.C.R.

CORNER — LEFT AS FOUND [X] FOUND AND TAGGED [] REESTABLISHED OBLITERATED CORNER [] REBUILT []

PHYSICAL DESCRIPTION OF CORNER FOUND; EVIDENCE AND METHOD USED TO IDENTIFY OR REESTABLISH

Found 5/8" rod 0.7 below ground surface.

PHYSICAL DESCRIPTION OF MONUMENTS REBUILT OR PERPETUATED

CALIFORNIA COORDINATE SYSTEM ORDER: FIRST [] SECOND [] THIRD [] STATIONS USED: NGS (USC & GS) [] STATE [] COUNTY [] OTHER [] STATION _____ STATION _____ ZONE _____ ELEVATION _____ NORTHINGS (Y) _____ EASTINGS (X) _____

SKETCH: (Include reference tie or witness points, remarks and topo of area)

23.37 East from nail & shiner in 4" x 6" fence post.
42.61 Northwest from nail & shiner in 3" x 4" fence post.

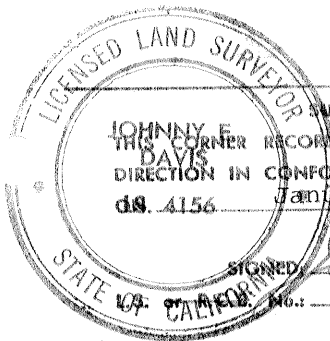

SURVEYOR'S CERTIFICATE
THE CORNER RECORD WAS PREPARED BY ME OR UNDER MY DIRECTION IN CONFORMANCE WITH THE LAND SURVEYORS ACT
No. 4156 January 31, 19 79
Signed: *Johnny E. Davis*
No.: 4156

SEAL

COUNTY SURVEYOR'S CERTIFICATE

THE CORNER RECORD WAS RECEIVED _____ 19 _____
AND EXAMINED AND FILED _____ 19 _____

BY: _____
TITLE: _____

DOCUMENT No. 3396

STATEMENT ON BACK OF SHEET

YES [] NO []