

#3392

CORNER RECORD

COUNTY OF Merced T 9S R 14E Mt. Diablo MERIDIAN CALIFORNIA

CORNER TYPE: GOV'T. CORNER MEANDER RANCHO CONTROL OTHER

CORNER IDENTIFICATION -- DATE OF VISIT 11-30-1977



Northwest corner of Lot 20, Block 22, (Section 22) as shown on Map of the Bliss Ranch Subdivision on file in Volume 7 of Plats, at page 43, M.C.R.

CORNER -- LEFT AS FOUND FOUND AND TAGGED REESTABLISHED OBLITERATED CORNER REBUILT

PHYSICAL DESCRIPTION OF CORNER FOUND; EVIDENCE AND METHOD USED TO IDENTIFY OR REESTABLISH

Found 1" O.D. pipe @ 0.6 below groundline tagged R.C.E. 6888

PHYSICAL DESCRIPTION OF MONUMENTS REBUILT OR PERPETUATED

CALIFORNIA COORDINATE SYSTEM ORDER: FIRST SECOND THIRD
STATIONS USED: NGS (USC & GS) STATE COUNTY OTHER STATION _____ STATION _____
ZONE _____ ELEVATION _____ NORTHINGS (Y) _____ EASTINGS (X) _____

SKETCH: (Include reference tie or witness points, remarks and topo of area)

31.54 Southeast from nail & shiner in railroad tie fence post
18.87 East from nail & shiner in railroad tie fence post
43.33 North from nail & shiner in power pole.

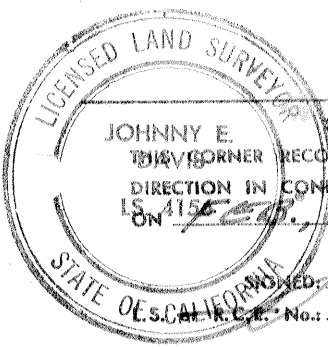

JOHNNY E. DAVIS SURVEYOR'S CERTIFICATE
THIS CORNER RECORD WAS PREPARED BY ME OR UNDER MY DIRECTION IN CONFORMANCE WITH THE LAND SURVEYORS ACT
ON FEB 9 1979
FILED: John E. Davis
4156

SEAL

COUNTY SURVEYOR'S CERTIFICATE

THE CORNER RECORD WAS RECEIVED _____ 19____
AND EXAMINED AND FILED _____ 19____

BY: _____
TITLE: _____

DOCUMENT No. 3392

STATEMENT ON BACK OF SHEET

YES NO