

NO. 315

CO RNER RECORD

COUNTY OF Merced T. 9S R. 14E Mt. Diablo MERIDIAN CALIFORNIA

CORNER TYPE: GOV'T. CORNER [] MEANDER [] RANCHO [] CONTROL [] OTHER [X]

CORNER IDENTIFICATION -- DATE OF VISIT June 6, 1976



Northwest corner of Lot 4, Block 24, (Section 24) as shown on the Map of the Bliss Ranch Subdivision on file in Volume 7 of plats at Page 44, M.C.R.

CORNER -- LEFT AS FOUND [X] FOUND AND TAGGED [] REESTABLISHED OBLITERATED CORNER [] REBUILT []

PHYSICAL DESCRIPTION OF CORNER FOUND; EVIDENCE AND METHOD USED TO IDENTIFY OR REESTABLISH

Found 4" x 4" redwood @ 0.6 feet down with 1" O.D. iron pipe with elbow on top at 0.1 feet northeast

PHYSICAL DESCRIPTION OF MONUMENTS REBUILT OR PERPETUATED

CALIFORNIA COORDINATE SYSTEM ORDER: FIRST [] SECOND [] THIRD [] STATIONS USED: NGS (USC & GS) [] STATE [] COUNTY [] OTHER [] STATION _____ STATION _____ ZONE _____ ELEVATION _____ NORTHINGS (Y) _____ EASTINGS (X) _____

SKETCH: (Include reference tie or witness points, remarks and topo of area)

- 104.77 Southeast of nail & shiner in telephone post
30.68 Southwest of nail & shiner in brace post
38.38 Northwest of nail & shiner in railroad tie fence post
17.38 North of nail & shiner in power pole

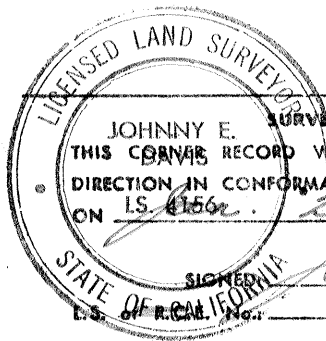

JOHNNY E. SURVEYOR'S CERTIFICATE THIS CORNER RECORD WAS PREPARED BY ME OR UNDER MY DIRECTION IN CONFORMANCE WITH THE LAND SURVEYORS ACT ON IS. 1562 29 19 80

SIGNATURE: Johnny E. Davis 1156

COUNTY SURVEYOR'S CERTIFICATE THE CORNER RECORD WAS RECEIVED Feb 25 19 80 AND EXAMINED AND FILED BY: Walter Mitchell TITLE:

DOCUMENT No. 3152

STATEMENT ON BACK OF SHEET

YES [] NO []

SEAL