

#3150

CO RNER RECORD

COUNTY OF Merced T. 9S R. 14E Mt. Diablo MERIDIAN CALIFORNIA

CORNER TYPE: GOV'T. CORNER [] MEANDER [] RANCHO [] CONTROL [] OTHER [XX]

CORNER IDENTIFICATION — DATE OF VISIT 12-2- 19 76



Northwest corner of Lot 4, Block 13, (Section 13) as shown on the Map of the Bliss Ranch Subdivision on file in Volume 7 of Plats, at page 41, M.C.R.

CORNER — LEFT AS FOUND [] FOUND AND TAGGED [XX] REESTABLISHED OBLITERATED CORNER [] REBUILT []

PHYSICAL DESCRIPTION OF CORNER FOUND; EVIDENCE AND METHOD USED TO IDENTIFY OR REESTABLISH

Found 4 x 4 redwood 0.4 below ground

PHYSICAL DESCRIPTION OF MONUMENTS REBUILT OR PERPETUATED

Found 4 x 4 redwood 0.4 below ground, set 60^d nail in center with plug L.S. 4156

CALIFORNIA COORDINATE SYSTEM ORDER: FIRST [] SECOND [] THIRD [] STATIONS USED: NGS (USC & GS) [] STATE [] COUNTY [] OTHER [] STATION _____ STATION _____ ZONE _____ ELEVATION _____ NORTHINGS (Y) _____ EASTINGS (X) _____

SKETCH: (Include reference tie or witness points, remarks and topo of area)

- 18.21 South from nail & shiner in railroad tie gate post.
- 5.58 West from nail & shiner in railroad tie brace post.
- 24.96 North from nail & shiner in railroad tie brace post.

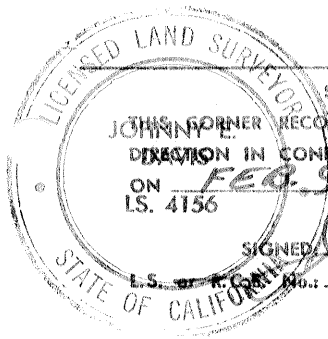

SURVEYOR'S CERTIFICATE

THE CORNER RECORD WAS PREPARED BY ME OR UNDER MY DIRECTION IN CONFORMANCE WITH THE LAND SURVEYORS ACT ON FEB. 9 19 79 L.S. 4156

SIGNED: John Ellavo

No. 4156

SEAL

COUNTY SURVEYOR'S CERTIFICATE

THE CORNER RECORD WAS RECEIVED _____ 19. AND EXAMINED AND FILED _____ 19.

BY: _____

TITLE: _____

DOCUMENT No. 3150

STATEMENT ON BACK OF SHEET

YES [] NO []