

3127

C NER RECORD

COUNTY OF Merced T. 9 S R. 15 E Mt. Diablo MERIDIAN CALIFORNIA

CORNER TYPE: GOV'T. CORNER [X] MEANDER [] RANCHO [] CONTROL [] OTHER [X]

CORNER IDENTIFICATION - DATE OF VISIT September 7, 19 76



Northwest corner of Block 22, (Section 22), as shown on the Map of the Bliss Ranch Subdivision on file in Volume 7 of plats page 46 M.C.R.

CORNER - LEFT AS FOUND [X] FOUND AND TAGGED [] REESTABLISHED OBLITERATED CORNER [] REBUILT []

PHYSICAL DESCRIPTION OF CORNER FOUND; EVIDENCE AND METHOD USED TO IDENTIFY OR REESTABLISH

Found 1-3/8" O.D. pipe with tag L.S. 656 at 0'6" below ground.

PHYSICAL DESCRIPTION OF MONUMENTS REBUILT OR PERPETUATED

CALIFORNIA COORDINATE SYSTEM ORDER: FIRST [] SECOND [] THIRD [] STATIONS USED: NGS (USC & GS) [] STATE [] COUNTY [] OTHER [] STATION _____ STATION _____ ZONE _____ ELEVATION _____ NORTHINGS (Y) _____ EASTINGS (X) _____

SKETCH: (Include reference tie or witness points, remarks and topo of area)

- 49.55 Northeast from air valve with gate.
- 25.79 West from nail & shiner in grape post.
- 5.53 East from nail & shiner in railroad tie post.
- 29.2 North of pole line 1/2 mile west.

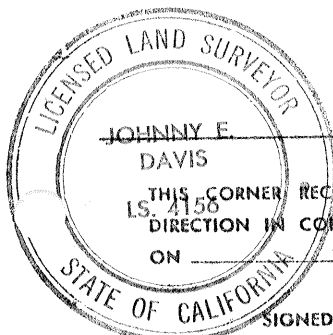

JOHNNY E. DAVIS SURVEYOR'S CERTIFICATE THIS CORNER RECORD WAS PREPARED BY ME OR UNDER MY DIRECTION IN CONFORMANCE WITH THE LAND SURVEYORS ACT ON January 29, 19 79 SIGNED: [Signature] L.S. or R.C.E. No.: 4156

SEAL

COUNTY SURVEYOR'S CERTIFICATE

THE CORNER RECORD WAS RECEIVED _____ 19____ AND EXAMINED AND FILED _____ 19____ BY: _____ TITLE: _____

DOCUMENT No. 3127

STATEMENT ON BACK OF SHEET

YES [] NO []