

3125

CC VER RECORD

COUNTY OF Merced T 9 S R 15 E Mt. Diablo MERIDIAN CALIFORNIA

CORNER TYPE: GOVT. CORNER [X] MEANDER [] RANCHO [] CONTROL [] OTHER []
DATE OF VISIT April 14, 1976



Northwest Corner of Lot 8, Block 21 (Section 21) of the Bliss Ranch Subdivision on file in Volume 7 of plats at page 46 of the M.C.R.

CORNER — LEFT AS FOUND [X] FOUND AND TAGGED [] REESTABLISHED OBLITERATED CORNER [] REBUILT []

PHYSICAL DESCRIPTION OF CORNER FOUND; EVIDENCE AND METHOD USED TO IDENTIFY OR REESTABLISH

Found 4" x 4" redwood 2° below dirt road with pipe 1" O.D. set in center with plug L.S. 3733. Top of pipe 1.7 below dirt road surface.

PHYSICAL DESCRIPTION OF MONUMENTS REBUILT OR PERPETUATED

CALIFORNIA COORDINATE SYSTEM ORDER: FIRST [] SECOND [] THIRD []
STATIONS USED: NGS (USC & GS) [] STATE [] COUNTY [] OTHER [] STATION _____ STATION _____
ZONE _____ ELEVATION _____ NORTHINGS (Y) _____ EASTINGS (X) _____

SKETCH: (Include reference tie or witness points, remarks and topo of area)

95.65 West from nail & shiner in power pole.
41.30 Northwest from nail & shiner in power pole.

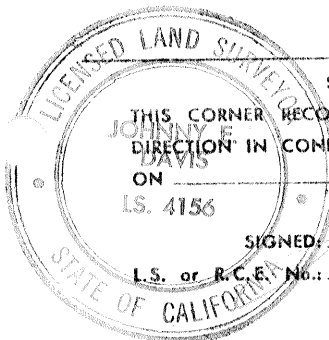

SURVEYOR'S CERTIFICATE

THIS CORNER RECORD WAS PREPARED BY ME OR UNDER MY DIRECTION IN CONFORMANCE WITH THE LAND SURVEYORS ACT ON January 30, 1979

SIGNED: *John E. Davis*

L.S. or R.C.E. No.: 4156

SEAL

COUNTY SURVEYOR'S CERTIFICATE

THE CORNER RECORD WAS RECEIVED _____ 19_____
AND EXAMINED AND FILED _____ 19_____
BY: _____

TITLE: _____

DOCUMENT No. 3125

STATEMENT ON BACK OF SHEET

YES [] NO []