

NO. 3125-J

CC IER RECORD

COUNTY OF Merced T. 9S R. 15E M.D.B. MERIDIAN CALIFORNIA

CORNER TYPE: GOVT. CORNER MEANDER RANCHO CONTROL OTHER

CORNER IDENTIFICATION — DATE OF VISIT June 3, 1977

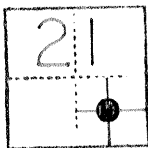

Northwest corner of Lot 31, Block 21, (Section 21) as shown on the Map of the Bliss Ranch Subdivision on file in Volume 7 of plats at page 46, M.C.R.

CORNER — LEFT AS FOUND FOUND AND TAGGED REESTABLISHED OBLITERATED CORNER REBUILT

PHYSICAL DESCRIPTION OF CORNER FOUND; EVIDENCE AND METHOD USED TO IDENTIFY OR REESTABLISH

Found 3 x 4 redwood post painted white on two sides at 0.5 below groundline. Monument will be destroyed BY CONSTRUCTION.

PHYSICAL DESCRIPTION OF MONUMENTS REBUILT OR PERPETUATED

Offset monument
Set 1" O.D. iron pipe tagged L.S. 4156@30 feet north of original corner on line with the northwest corner of Lot 18, Block 21, at groundline.

CALIFORNIA COORDINATE SYSTEM ORDER: FIRST SECOND THIRD
STATIONS USED: NGS (USC & GS) STATE COUNTY OTHER STATION _____ STATION _____
ZONE _____ ELEVATION _____ NORTHINGS (Y) _____ EASTINGS (X) _____

SKETCH: (Include reference tie or witness points, remarks and topo of area)

Ties to 30 foot offset

46.74 Southeast from nail & shiner in power pole
68.61 South from nail & shiner in power pole
62.19 West from nail & shiner in utility pole
38.74 South from nail & shiner in power pole

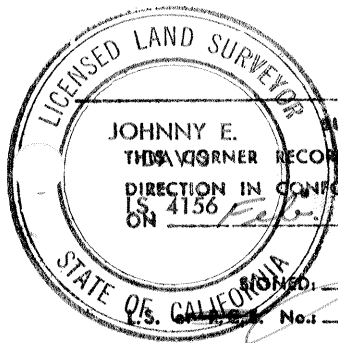

SURVEYOR'S CERTIFICATE
THIS CORNER RECORD WAS PREPARED BY ME OR UNDER MY DIRECTION IN CONFORMANCE WITH THE LAND SURVEYORS ACT
ON Feb. 29, 1980
L.S. 4156
No. 4156

SEAL

COUNTY SURVEYOR'S CERTIFICATE

THE CORNER RECORD WAS RECEIVED _____ 19____
AND EXAMINED AND FILED _____ 19____
BY: _____
TITLE: _____
DOCUMENT: 3125-J
STATEMENT ON BACK OF SHEET YES NO