

3123-I

CO RNER RECORD

COUNTY OF Merced T. 9 S. R. 15 E Mt. Diablo MERIDIAN CALIFORNIA

CORNER TYPE: GOV'T. CORNER [] MEANDER [] RANCHO [] CONTROL [] OTHER [x] Lot Corner
CORNER IDENTIFICATION - DATE OF VISIT November 5, 1976

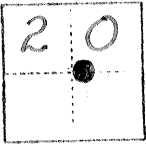

Northwest corner Lot 19, Block 20 (Section 20) of the Bliss Ranch Subdivision on file in Volume 7 of plats at page 45 of M.C.R.

CORNER - LEFT AS FOUND [] FOUND AND TAGGED [] REESTABLISHED OBLITERATED CORNER [] REBUILT [x]

PHYSICAL DESCRIPTION OF CORNER FOUND; EVIDENCE AND METHOD USED TO IDENTIFY OR REESTABLISH

Found 4" x 4" redwood 0.2 below ground, also 1" O.D. pipe 0.45 Northeast of redwood.

PHYSICAL DESCRIPTION OF MONUMENTS REBUILT OR PERPETUATED

Found 4" x 4" redwood 0.2 below ground, also 1" O.D. pipe 0.45 North/East of monument. Set 1" O.D. pipe in center of redwood with plug L.S. 4156.

CALIFORNIA COORDINATE SYSTEM ORDER: FIRST [] SECOND [] THIRD []
STATIONS USED: NGS (USC & GS) [] STATE [] COUNTY [] OTHER [] STATION _____ STATION _____
ZONE _____ ELEVATION _____ NORTHINGS (Y) _____ EASTINGS (X) _____

SKETCH: (Include reference tie or witness points, remarks and topo of area)

15.56 East from nail & shiner in railroad tie post.
6.57 West from nail & shiner in railroad tie.

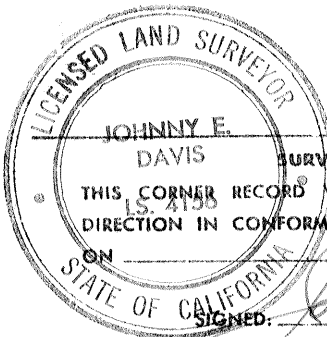

SURVEYOR'S CERTIFICATE
THIS CORNER RECORD WAS PREPARED BY ME OR UNDER MY DIRECTION IN CONFORMANCE WITH THE LAND SURVEYORS ACT ON January 30, 1979
SIGNED: [Signature]
L.S. or R.C.E. No. 4156

SEAL

COUNTY SURVEYOR'S CERTIFICATE

THE CORNER RECORD WAS RECEIVED _____ 19____ AND EXAMINED AND FILED _____ 19____ BY: _____ TITLE: _____

DOCUMENT No. 3123-I

STATEMENT ON BACK OF SHEET

YES [] NO []