

#3122

CC IER RECORD

COUNTY OF Merced T. 9 S R. 15 E Mt. Diablo MERIDIAN CALIFORNIA

CORNER TYPE: GOV'T. CORNER MEANDER RANCHO CONTROL OTHER

CORNER IDENTIFICATION -- DATE OF VISIT May 20, 19 76

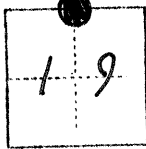

Northwest corner of Lot 4, Block 19 (Section 19) of the Bliss Ranch Subdivision on file in Volume 7 of plats at page 40 of M.C.R.

CORNER -- LEFT AS FOUND FOUND AND TAGGED REESTABLISHED OBLITERATED CORNER REBUILT

PHYSICAL DESCRIPTION OF CORNER FOUND; EVIDENCE AND METHOD USED TO IDENTIFY OR REESTABLISH

Found 4" x 4" redwood with 3/4" iron pipe on North side 0⁶ feet below dirt road surface.

PHYSICAL DESCRIPTION OF MONUMENTS REBUILT OR PERPETUATED

CALIFORNIA COORDINATE SYSTEM ORDER: FIRST SECOND THIRD
STATIONS USED: NGS (USC & GS) STATE COUNTY OTHER STATION _____ STATION _____
ZONE _____ ELEVATION _____ NORTHINGS (Y) _____ EASTINGS (X) _____

SKETCH: (Include reference tie or witness points, remarks and topo of area)

32.85 Southeast from mark on 42" stand pipe.
36.39 Northeast from center line 12" irrigation valve.

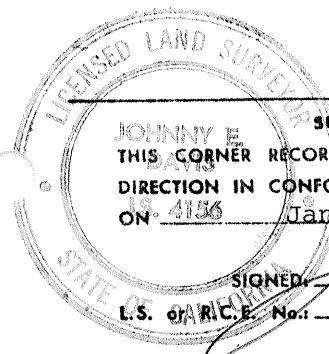

SURVEYOR'S CERTIFICATE

JOHNNY E. DAVIS
THIS CORNER RECORD WAS PREPARED BY ME OR UNDER MY DIRECTION IN CONFORMANCE WITH THE LAND SURVEYORS ACT ON 4156 January 29, 19 79.

SIGNED: *Johnny E. Davis*
L.S. or R.C.E. No.: 4156

SEAL

COUNTY SURVEYOR'S CERTIFICATE

THE CORNER RECORD WAS RECEIVED _____ 19_____
AND EXAMINED AND FILED _____ 19_____
BY: _____
TITLE: _____

DOCUMENT No. 3122

STATEMENT ON BACK OF SHEET

YES NO