

3121

CC JER RECORD

COUNTY OF Merced T. 9 S R. 15 E Mt. Diablo MERIDIAN CALIFORNIA

CORNER TYPE: GOV'T. CORNER [] MEANDER [] RANCHO [] CONTROL [] OTHER [X]

CORNER IDENTIFICATION — DATE OF VISIT October 4, 19 76

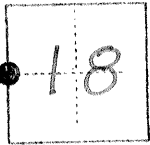

Northwest corner Lot 24, Block 18 (Section 18) of Bliss Ranch Subdivision on file in Volume 7 of plats at page 40, M.C.R.

CORNER — LEFT AS FOUND [] FOUND AND TAGGED [] REESTABLISHED OBLITERATED CORNER [] REBUILT []

PHYSICAL DESCRIPTION OF CORNER FOUND; EVIDENCE AND METHOD USED TO IDENTIFY OR REESTABLISH

Set 1" O.D. pipe 0'4 below road surface with plug L.S. 4156.

Set on line with and at distance shown on Map of Bliss Ranch Subdivision on file in Volume 7 at page 40 of M.C.R., Found Northwest corner of Lot 25 and Northwest corner of Lot 8 of Block 18, total distance 4081.21

PHYSICAL DESCRIPTION OF MONUMENTS REBUILT OR PERPETUATED

CALIFORNIA COORDINATE SYSTEM ORDER: FIRST [] SECOND [] THIRD [] STATIONS USED: NGS (USC & GS) [] STATE [] COUNTY [] OTHER [] STATION _____ STATION _____ ZONE _____ ELEVATION _____ NORTHINGS (Y) _____ EASTINGS (X) _____

SKETCH: (Include reference tie or witness points, remarks and topo of area)

- 70.57 Northeast from nail & shiner in power pole.
21.99 Northeast from nail & shiner in corner post.
37.2 Northeast from East face top of 48" concrete standpipe.
52.0 Northeast from centerline of well & pump.
30.0 East from powerline North/South.
25.88 Southeast from nail & shiner in corner fence post.
1320.00 N 01° 01' W from Northwest corner of Lot 25.
2761.20 S 01° 01' E from Northwest corner of Lot 8.

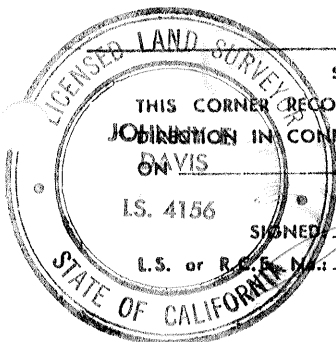

SURVEYOR'S CERTIFICATE

THIS CORNER RECORD WAS PREPARED BY ME OR UNDER MY JOHNSON IN CONFORMANCE WITH THE LAND SURVEYORS ACT ON DAVIS January 29, 19 79 L.S. 4156 SIGNED [Signature] L.S. or R.E. No. 4156

SEAL

COUNTY SURVEYOR'S CERTIFICATE

THE CORNER RECORD WAS RECEIVED _____ 19 ____ AND EXAMINED AND FILED _____ 19 ____ BY: _____ TITLE: _____

DOCUMENT No. 3121

STATEMENT ON BACK OF SHEET

YES [] NO []