

#3107

CO ER RECORD

COUNTY OF Merced T. 9S R. 15E Mt. Diablo MERIDIAN CALIFORNIA

CORNER TYPE: GOV'T. CORNER MEANDER RANCHO CONTROL OTHER
CORNER IDENTIFICATION — DATE OF VISIT December 18, 1979

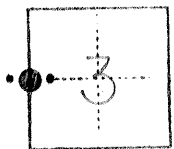

West 1/4 corner Section 3

CORNER — LEFT AS FOUND FOUND AND TAGGED REESTABLISHED OBLITERATED CORNER REBUILT

PHYSICAL DESCRIPTION OF CORNER FOUND; EVIDENCE AND METHOD USED TO IDENTIFY OR REESTABLISH

Found old 3 x 3 redwood at 1.3 feet below groundline. Also found 5/8" re-bar with aluminum cap at 1.0 below groundline and at 0.25 northwest of redwood. Monument will be destroyed by construction of canal.

PHYSICAL DESCRIPTION OF MONUMENTS REBUILT OR PERPETUATED

Set 1" O.D. iron pipe at groundline with plug I.S. 4156 for offset monuments at 25 feet east on the Mid Section line of Section 3, 9/15, and 25 feet west on the Mid Section line of Section 4, 9/15.

CALIFORNIA COORDINATE SYSTEM ORDER: FIRST SECOND THIRD
STATIONS USED: NGS (USC & GS) STATE COUNTY OTHER STATION _____ STATION _____
ZONE _____ ELEVATION _____ NORTHINGS (Y) _____ EASTINGS (X) _____

SKETCH: (Include reference tie or witness points, remarks and topo of area)

Ties to easterly offset monument.
119.12 Southeast from nail & shiner in power pole
70.03 East from scribed "X" on the north side of 36" standpipe
131.91 North from nail & shiner in power pole
Ties to westerly offset monument.
117.66 Southwest from nail & shiner in power pole
20.78 East from scribed "X" on north side of 36" standpipe
135.63 Northwest from nail & shiner in power pole

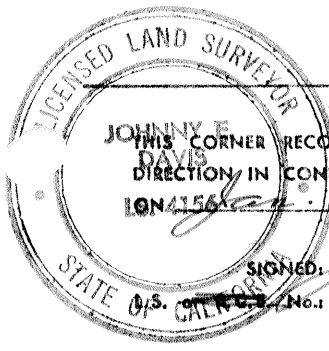

SURVEYOR'S CERTIFICATE
THIS CORNER RECORD WAS PREPARED BY ME OR UNDER MY DIRECTION IN CONFORMANCE WITH THE LAND SURVEYORS ACT
LON 4156 Jan. 20 1980
SIGNED: *Johnny E. Davis*
No. 1

SEAL

COUNTY SURVEYOR'S CERTIFICATE
THE CORNER RECORD WAS RECEIVED Feb. 25 1980
AND EXAMINED AND FILED BY: *Walter Mitchell*
TITLE: _____
DOCUMENT No. 3107
STATEMENT ON BACK OF SHEET YES NO