

309

CORNER RECORD

COUNTY OF Merced T. 9 South R. 10 East Mt. Diablo MERIDIAN CALIFORNIA

CORNER TYPE: GOV'T. CORNER MEANDER RANCHO CONTROL OTHER

CORNER IDENTIFICATION — DATE OF VISIT January 16, 19 79

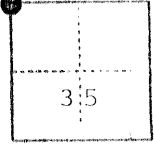

NW Corner, Section 35

CORNER — LEFT AS FOUND FOUND AND TAGGED REESTABLISHED OBLITERATED CORNER REBUILT

PHYSICAL DESCRIPTION OF CORNER FOUND; EVIDENCE AND METHOD USED TO IDENTIFY OR REESTABLISH

2-1/2" O.D. U.S.B.R. Brass Cap on 2" O.D. iron pipe stamped RCE 5905 @ 0.3 feet up.

PHYSICAL DESCRIPTION OF MONUMENTS REBUILT OR PERPETUATED

CALIFORNIA COORDINATE SYSTEM ORDER: FIRST SECOND THIRD STATIONS USED: NGS (USC & GS) STATE COUNTY OTHER STATION _____ ELEVATION _____ NORTHINGS (Y) _____ EASTINGS (X) _____

SKETCH: (include reference tie or witness points, remarks and topo of area)

9.00 NORTH OF 4"X4" WITNESS POST.
7.48 EAST OF 4"X4" WITNESS POST.
20.43 SOUTH OF NAIL & SHINER IN RAILROAD TIE POST.
1.26 EAST OF NAIL & SHINER IN RAILROAD TIE POST.

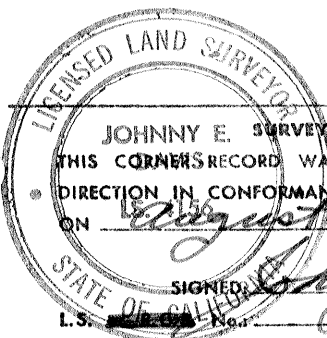
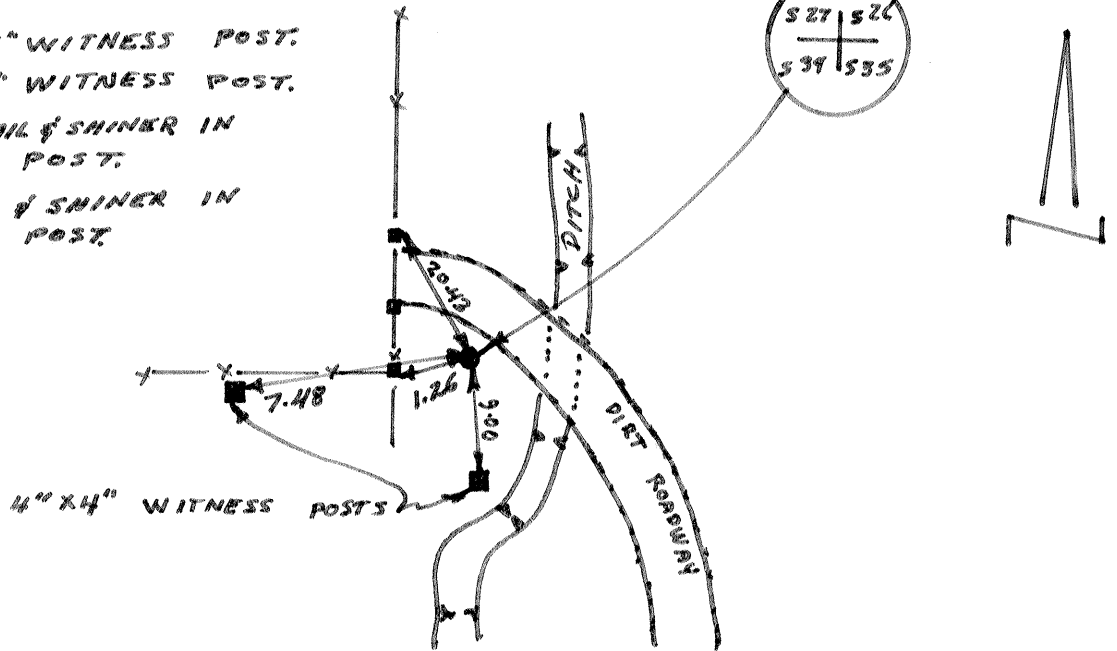

JOHNNY E. SURVEYOR'S CERTIFICATE
THIS CORNER RECORD WAS PREPARED BY ME OR UNDER MY DIRECTION IN CONFORMANCE WITH THE LAND SURVEYORS ACT ON August 10 19 79
SIGNED: Johnny E. Davis
L.S. No. 4156

COUNTY SURVEYOR'S CERTIFICATE
THE CORNER RECORD WAS RECEIVED _____ 19 ____
AND EXAMINED AND FILED _____ 19 ____
BY: _____
TITLE: _____
DOCUMENT No. 3097
STATEMENT ON BACK OF SHEET YES NO

SEAL