

CORNER RECORD

Document Number 3095

City of _____ County of Merced, California

Brief Legal Description NE Sec. Corner Sec.35, T.9 S., R.10 E., M.D.M.&B.

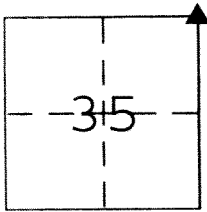

CORNER TYPE

Government Corner Control
Meander Property
Rancho Other
Date of Survey 02-08-2013

COORDINATES (Optional)

N. _____
E. _____
Zone _____ NAD27 NAD83
NAD83 Epoch _____
Elev. _____
Vert. Datum: NGVD29 NAVD88
Meas. Units: Metric Imperial

Corner - Left as found Found and tagged Established Reestablished Rebuilt

Identification and type of corner found: Evidence used to identify or procedure used to establish or reestablish the corner:
Found 2 1/4" Brass Disk set in concrete with no markings, down 0.5' in monument well per R.S. vol.7 page 49.

A description of the physical condition of the monument as found and as set or reset: Monument was found in good condition.

SURVEYOR'S STATEMENT

This Corner Record was prepared by me or under my direction in conformance with

the Land Surveyor's Act on MARCH 21 2013

Signed Bradley D. Buller P.L.S. or R.C.E. No. L 7659

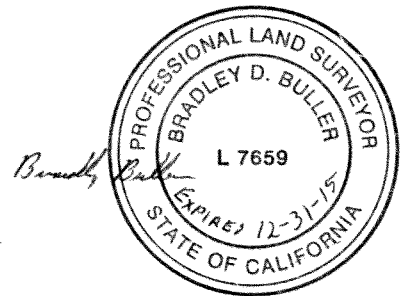

COUNTY SURVEYOR'S STATEMENT

This Corner Record was received March 21, 2013

and examined and filed April 29, 2013

Signed [Signature] P.L.S. or R.C.E. No. 4895

Title Acting County Surveyor

County Surveyor's Comment _____

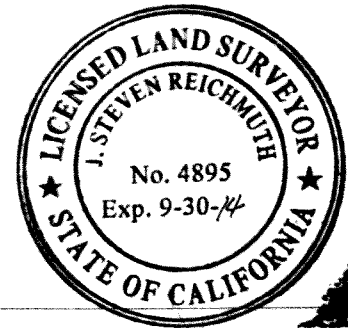

N. E. CORNER OF SEC. 35

