

CORNER RECORD

Document Number 3036

City of _____ County of MERCED, California

Brief Legal Description N 1/4 COR. SECT. 19, T10S R 12E, MOBEM

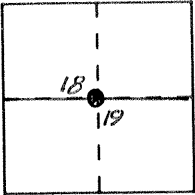

CORNER TYPE

Government Corner Control
 Meander Property
 Rancho Other
 Date of Survey 6-27-90

COORDINATES (Optional)

N. _____
 E. _____
 Zone _____ Datum _____
 Elev. _____

Corner — Left as found Found and tagged Established Reestablished Rebuilt

Identification and type of corner found: Evidence used to identify or procedure used to establish or reestablish the corner: SET SPIKE 29.85' S. OF 1/2" I. PIPE SHOWN ON SB PM 6
DUG 2' deep - FOUND NOTHING.

A description of the physical condition of the monument as found and as set or reset: 3/8" x 8" SPIKE
SET FLUSH

SURVEYOR'S STATEMENT

This Corner Record was prepared by me or under my direction in conformance with the Land Surveyors' Act on JUNE 27, 19 90.

Signed Ralph N. Scheel, Jr. L.S. or R.C.E. Number LS 3730
LIC EXP 6-30-92

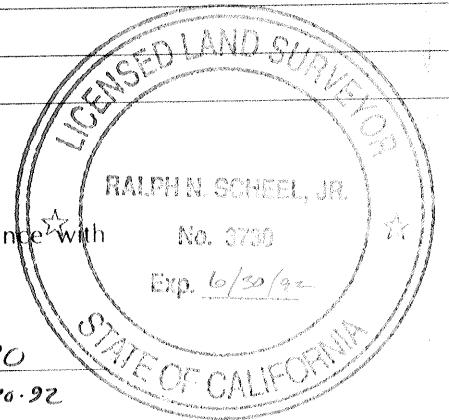

COUNTY SURVEYOR'S STATEMENT

This Corner Record was received August 19 90 and examined and filed August 22, 19 90.

Signed Roy L. Turney Title Dep. Co. Surveyor

County Surveyor's Comment COR. NO. 3036 OK

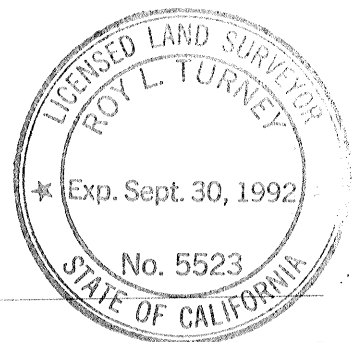

18
 |
 19
 T10S R 12E
 MOB. E.M.

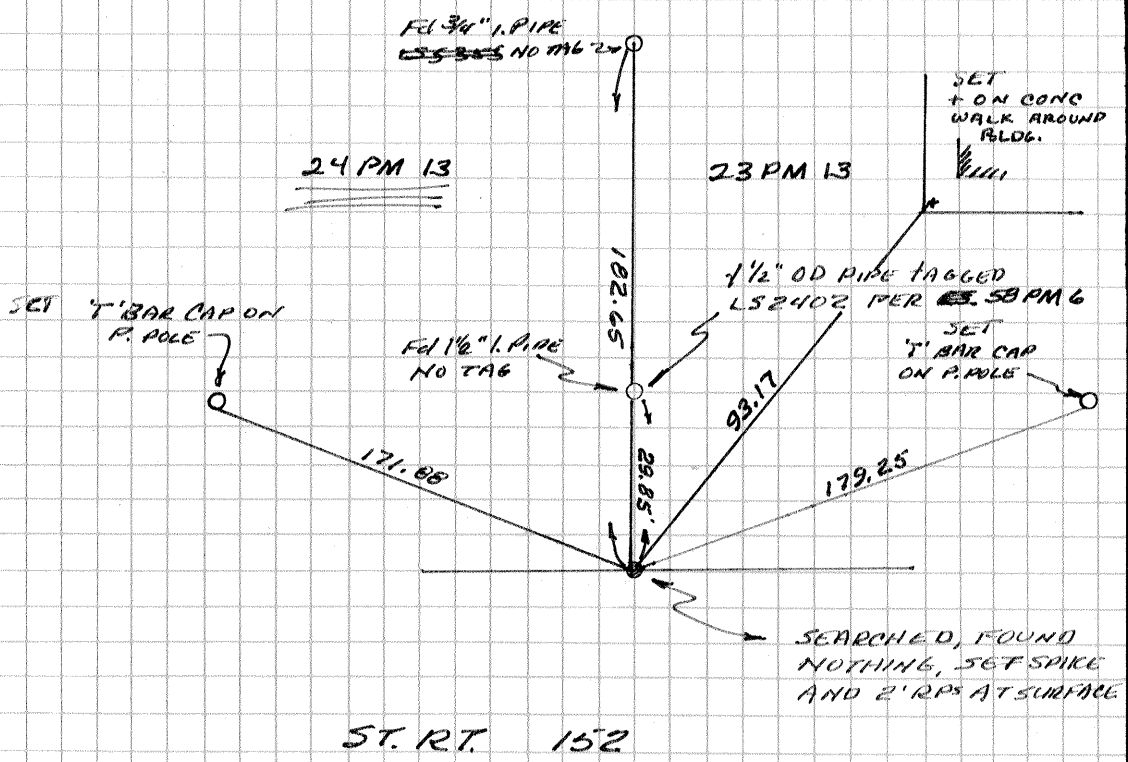

58 PM 6
 5' RS 40
 24 PM 13
 23 PM 13